

MT. VIEW MIDDLE SCHOOL – CAFETERIA

CONSOLIDATED DISTRICT/PRECINCTS: 03-02 AND 03-05

CHECK-IN

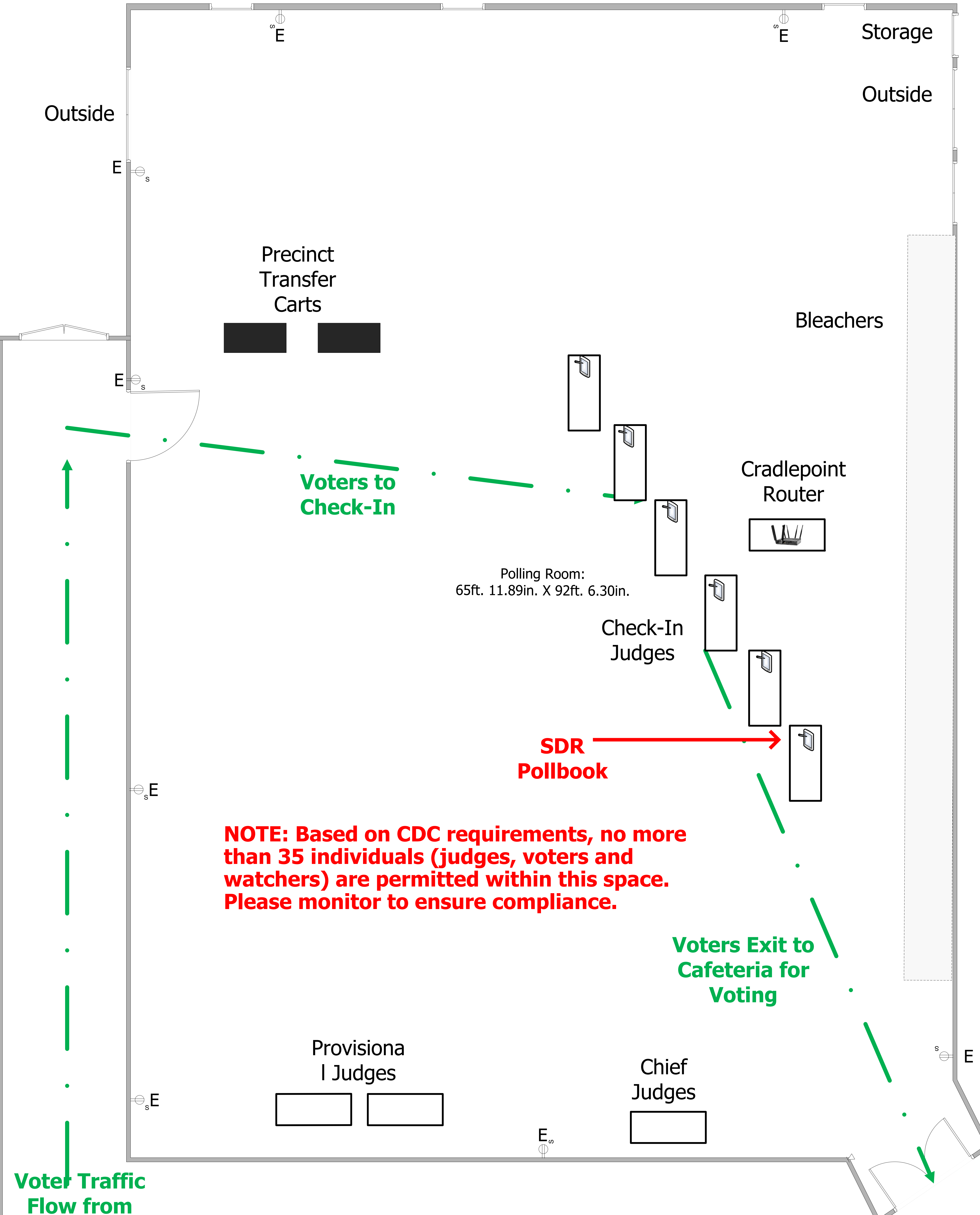

NOTE: Based on CDC requirements, no more than 35 individuals (judges, voters and watchers) are permitted within this space. Please monitor to ensure compliance.

Voter Traffic Flow from Main Building Entrance

E – Electric
V – Voter
← Voter Flow

FOR MAXIMUM VOTER PRIVACY, EFFICIENT VOTER FLOW AND SOCIAL DISTANCING REQUIREMENTS, POLLING PLACE MUST BE SETUP AS INDICATED. USE SUGGESTED CONFIGURATION FOR SETTING UP BOOTHS.

Mount View Middle School

Upper Level

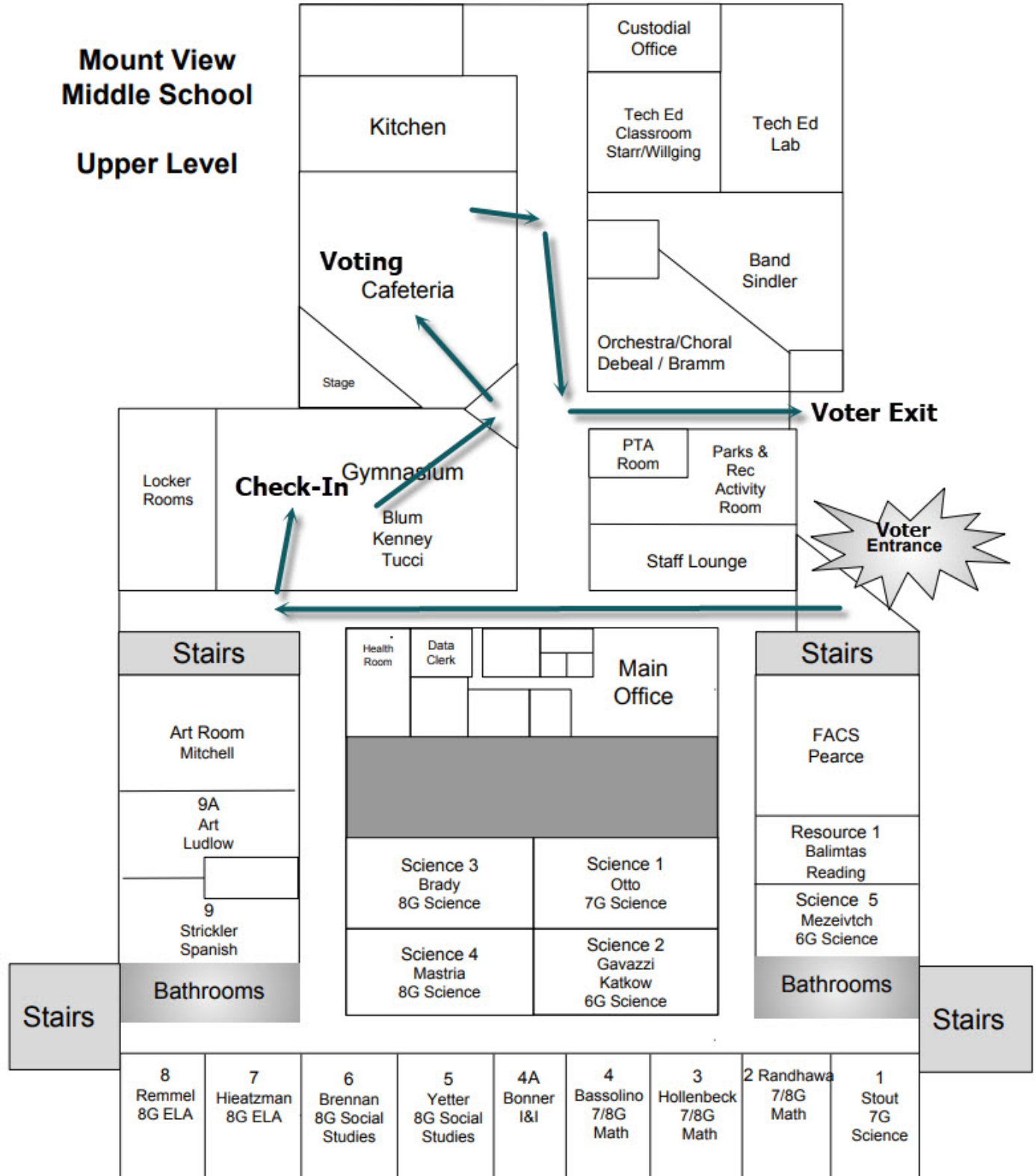

MT. VIEW MIDDLE SCHOOL – CAFETERIA

CONSOLIDATED DISTRICT/PRECINCTS: 03-02 AND 03-05 VOTING

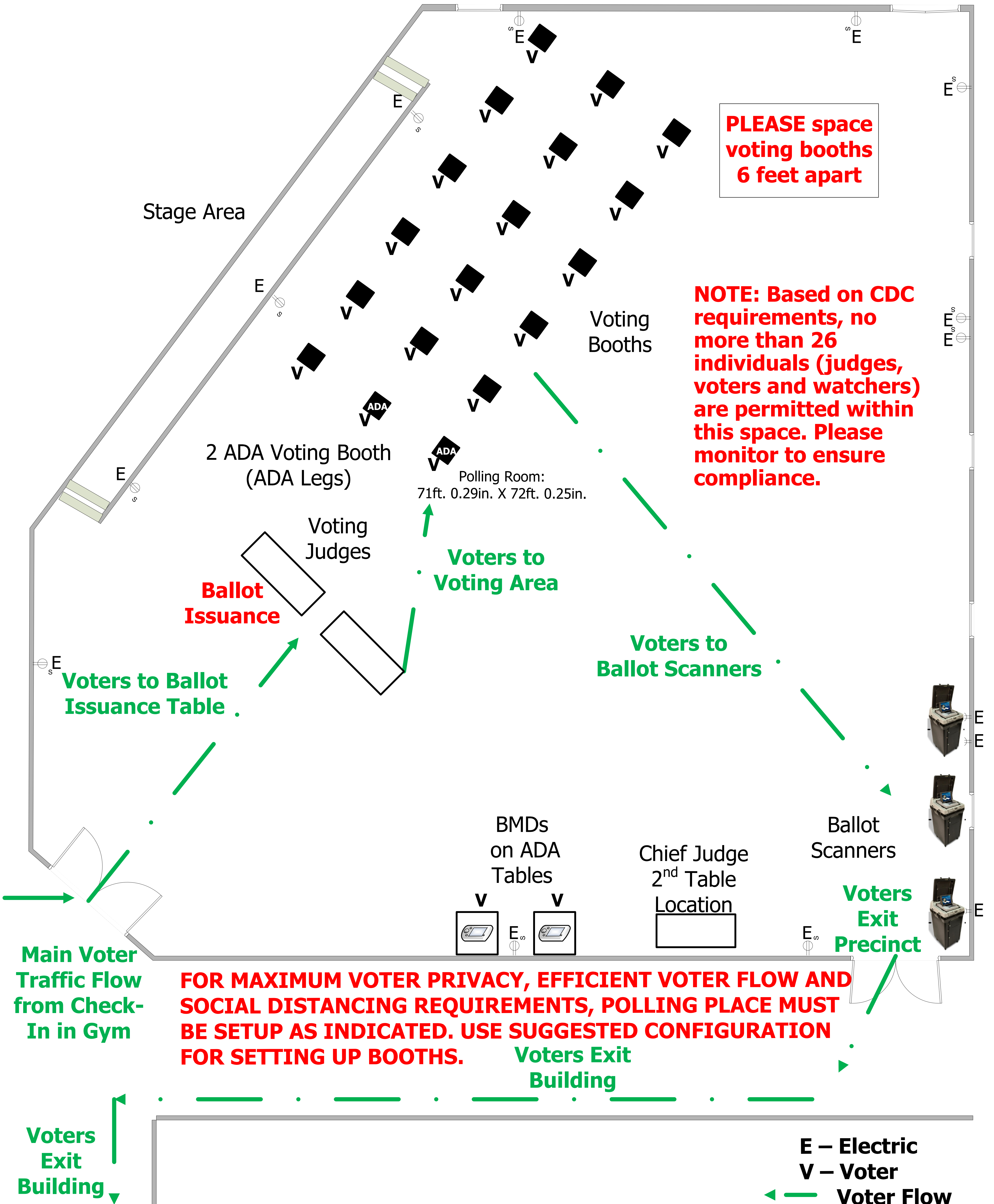

Allegany County Board of Elections



Memorandum

To: State Board Members

From: Members of the Allegany County Board of Elections

Date: August 3, 2020

Re: Consolidation of Precincts for the 2020 Presidential General Election

Due to the ongoing health crisis, we have found it necessary to consolidate the following polling places in order to adequately staff polling places for the upcoming general election. We have based our decisions on an 80% overall turnout for the election. Of that 80% turnout, we have estimated that 60% would vote in person and 40% would vote by mail. We did our best to make sure that the consolidations selected have minimal impact on voters on election day. We have provided additional information that shows the combined registration numbers for each proposed consolidation, polling place name, voting equipment, election judge information, and a site layout. Based on the consolidation, Allegany County will have 20 polling places for the 2020 Presidential General Election instead of 36.

If you have any questions, feel free to contact this office at your earliest convenience. Thank you for your consideration.

District/Precinct	Consolidate With
001-000 & 021-000	003-000
002-000	016-000
004-002, 004-003, 004-005, & 004-008	004-004
005-006	005-004
006-001, 006-003, & 006-005	006-006
007-001 & 031-000	007-002
009-000	010-000
029-002 & 029-003	029-001

Consolidation of 001-000, 003-000, and 021-000

Combined Registration 2,138

**80% Overall Turnout = 1,711 60% In Person Voting = 1,027 40% VBM = 685
Vote at Flintstone Volunteer Fire Department (003-000)**

Voting Equipment

**2 Pollbooks
6 Voting Booths
1 BMD
1 DS200**

Election Judges

**2 Chief Judges
1 Ballot Judge
1 Scanning Judge
3 Voting Judges**

District 001-000 - Active Registration 647

80% Overall Turnout = 518 60% In Person Voting = 311 40% VBM = 208

Voting Equipment

**2 Pollbooks
4 Voting Booths
1 BMD
1 DS200**

Election Judges

**2 Chief Judges
1 Ballot Issue Judge
1 Scanning Judge
2 Voting Judges**

District 003-000 – Active Registration 692

80% Overall Turnout = 554 60% In Person Voting = 333 40% VBM = 222

Voting Equipment

**2 Pollbooks
4 Voting Booths
1 BMD
1 DS200**

Election Judges

**2 Chief Judges
1 Ballot Issue Judge
1 Scanning Judge
2 Voting Judges**

District 021-000 – Active Registration 799

80% Overall Turnout = 640 60% In Person Voting = 384 40% VBM = 256

Voting Equipment

**2 Pollbooks
2 Voting Booths
1 BMD
1 DS200**

Election Judges

**2 Chief Judges
1 Ballot Issue Judge
1 Scanning Judge
2 Voting Judges**

40'3"

Bathroom

4'10"

7'1"

Provisional Ballot Table

Flintstone Fire Department

01-000

03-000

21-000

Booth

Booth

Booth

Booth

Booth

Booth

4'10"

38'5"

Kitchen

20'

ADA Table & BMD

Ballot Issue Table

Check-In Table

Check In Table

40'3"

25'

CS200

Main Entrance

5'6"

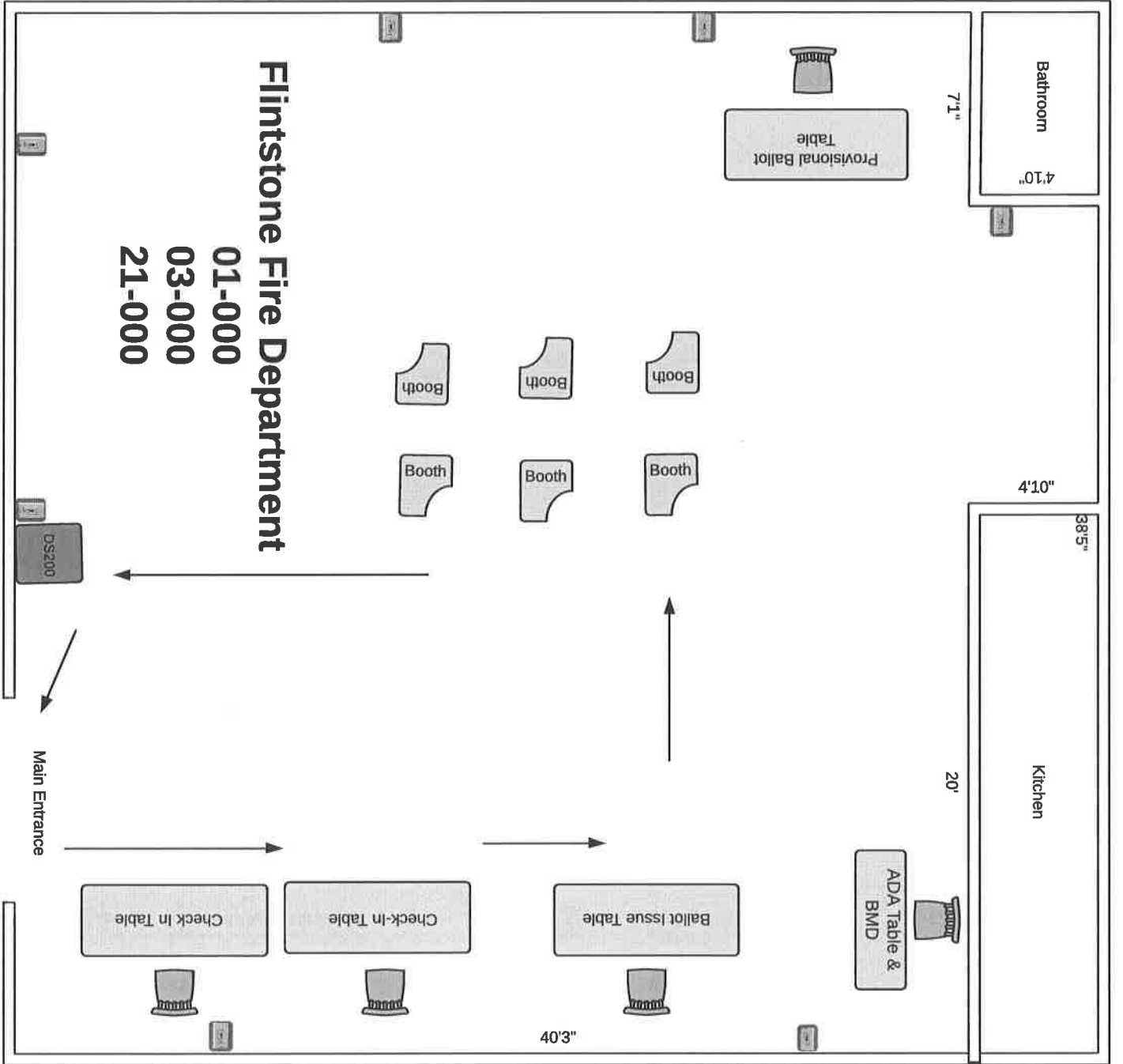

Consolidation of 002-000 & 016-000 – Combined Registration 2,150
80% Overall Turnout = 1,720 60% In Person Voting = 1,032 40% VBM = 688
Vote at the Department of Emergency Services (016-000)

Voting Equipment

2 Pollbooks
6 Voting Booths
1 BMD
1 DS200

Election Judges

2 Chief Judges
1 Ballot Issue Judge
1 Scanning Judge
3 Voting Judges

District 002-000 – Active Registration – 717
80% Overall Turnout = 574 60% In Person Voting = 345 40% VBM = 230

Voting Equipment

2 Pollbooks
2 Voting Booths
1 BMD
1 DS200

Election Judges

2 Chief Judges
1 Ballot Issue Judge
1 Scanning Judge
2 Voting Judges

District 016-000 – Active Registration – 1,433
80% Overall Turnout = 1,147 60% In Person Voting = 689 40% VBM = 459

Voting Equipment

2 Pollbooks
4 Voting Booths
1 BMD
1 DS200

Election Judges

2 Chief Judges
1 Ballot Issue Judge
1 Scanning Judge
2 Voting Judges

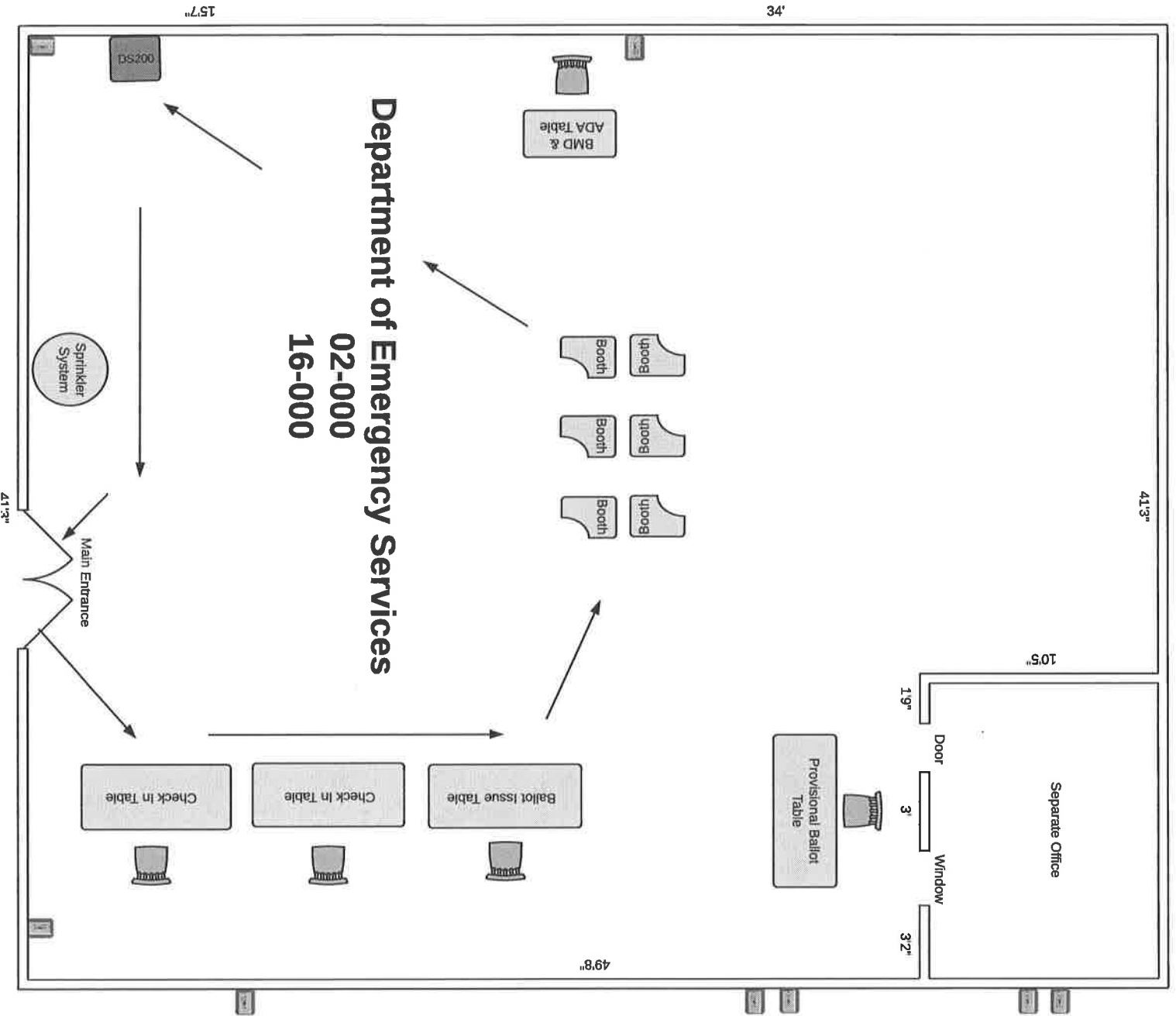

4'

15'7"

41'3"

10'5"

1'9"

3'

3'2"

49'8"

41'3"

Department of Emergency Services

02-000

16-000

BMD & ADA Table

Booth
Booth
Booth
Booth
Booth
Booth

Provisional Ballot Table

Separate Office

Door Window

Ballot Issue Table
Check In Table
Check In Table

Sprinkler System

Main Entrance

DS200

Consolidation Proposal for 2020 Presidential General Election

Consolidation of 004-002, 004-003, 004-004, 004-005, 004-008

Combined Registration 5,173

80% Overall Turnout = 4,139 60% In Person Voting = 2,484 40% VBM = 1,656

Vote at Fort Hill High School – Cafeteria (004-004)

Voting Equipment

5 Pollbooks
13 Voting Booths
2 BMDs
2 DS200s

Election Judges

2 Chief Judges
3 Check-in Judges
3 Ballot Issue Judges
2 Scanning Judges
5 Voting Judges

District 004-002 – Active Registration 746

80% Overall Turnout = 597 60% In Person Voting = 359 40% VBM = 239

Voting Equipment

2 Pollbooks
2 Voting Booths
1 BMD
1 DS200

Election Judges

2 Chief Judges
1 Ballot Issue Judge
1 Scanning Judge
2 Voting Judges

District 004-003 – Active Registration 1,118

80% Overall Turnout = 895 60% In Person Voting = 537 40% VBM = 358

Voting Equipment

2 Pollbooks
3 Voting Booths
1 BMD
1 DS200

Election Judges

2 Chief Judges
1 Ballot Issue Judge
1 Scanning Judge
2 Voting Judges

District 004-004 – Active Registration 1,329

80% Overall Turnout = 1,064 60% In Person Voting = 639 40% VBM = 426

Voting Equipment

2 Pollbooks
4 Voting Booths
1 BMD
1 DS200

Election Judges

2 Chief Judges
1 Ballot Issue Judge
1 Scanning Judge
2 Voting Judges

District 004-005 – Active Registration 749

80% Overall Turnout = 60060% In Person Voting = 360

40% VBM = 240

Voting Equipment

2 Pollbooks
2 Voting Booths
1 BMD
1 DS200

Election Judges

2 Chief Judges
1 Ballot Issue Judge
1 Scanning Judge
2 Voting Judges

District 004-008 – Active Registration 1,235

80% Overall Turnout = 98860% In Person Voting = 593

40% VBM = 396

Voting Equipment

2 Pollbooks
3 Voting Booths
1 BMD
1 DS200

Election Judges

2 Chief Judges
1 Ballot Issue Judge
1 Scanning Judge
2 Voting Booths

Fort Hill High School

- 04-002
- 04-003
- 04-004
- 04-005
- 04-008

53'3"

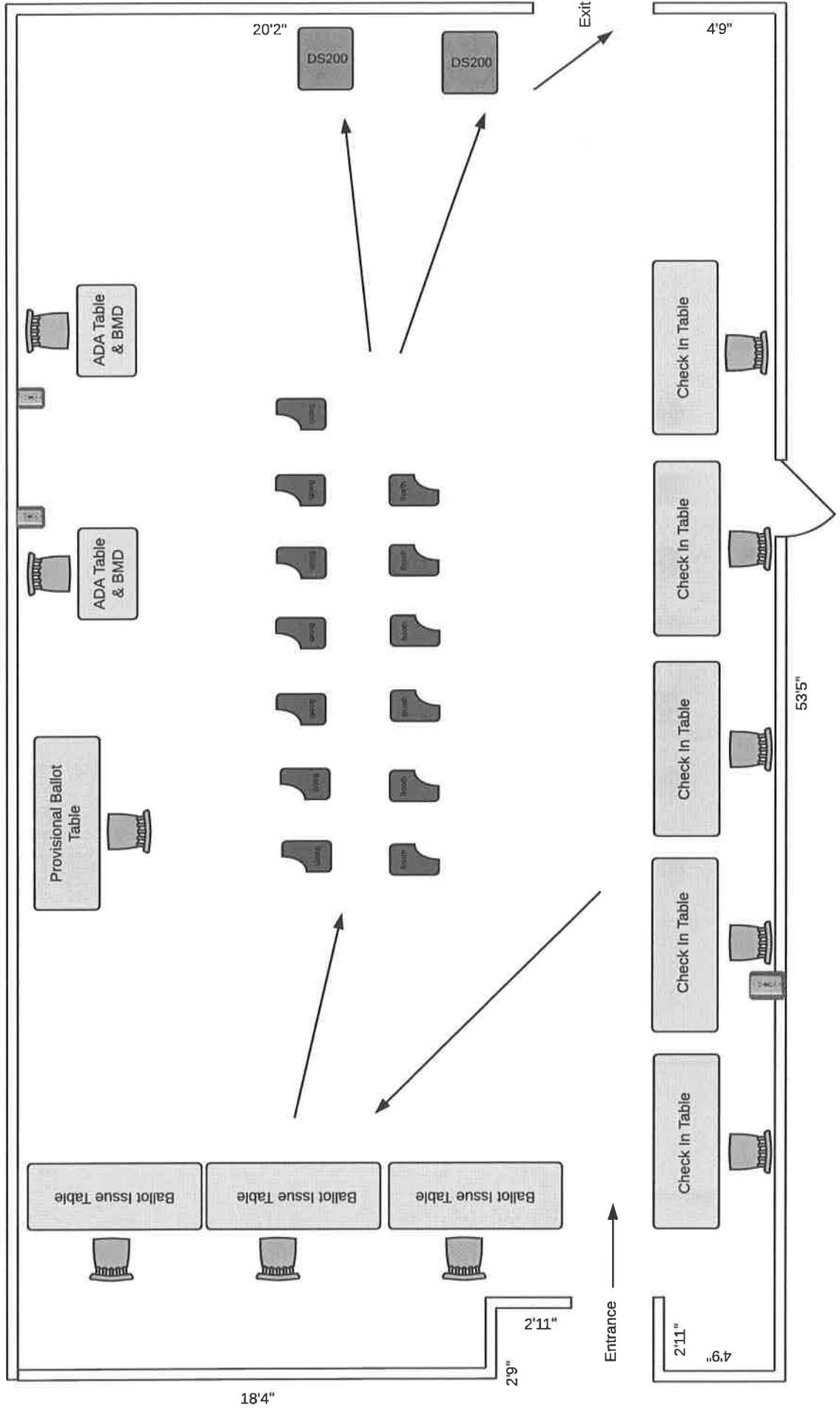

Consolidation of 005-004 and 005-006 - Combined Registration 1,599
80% Overall Turnout = 1,280 60% In Person Voting = 768 40% VBM = 512
Vote at Braddock Middle School – Cafeteria (005-004)

Voting Equipment

2 Pollbooks
4 Voting Booths
1 BMD
1 DS200

Election Judges

2 Chief Judges
1 Ballot Issue Judge
1 Scanning Judge
2 Voting Judges

District 005-004 – Active Registration 1,083
80% Overall Turnout = 867 60% In Person Voting = 537 40% VBM = 347

Voting Equipment

2 Pollbooks
3 Voting Booths
1 BMD
1 DS200

Election Judges

2 Chief Judges
1 Ballot Issue Judge
1 Scanning Judge
2 Voting Judges

District 005-006 – Active Registration 516
80% Overall Turnout = 413 60% In Person Voting = 248 40% VBM = 166

Voting Equipment

2 Pollbooks
2 Voting Booths
1 BMD
1 DS200

Election Judges

2 Chief Judges
1 Ballot Issue Judge
1 Scanning Judge
2 Voting Judges

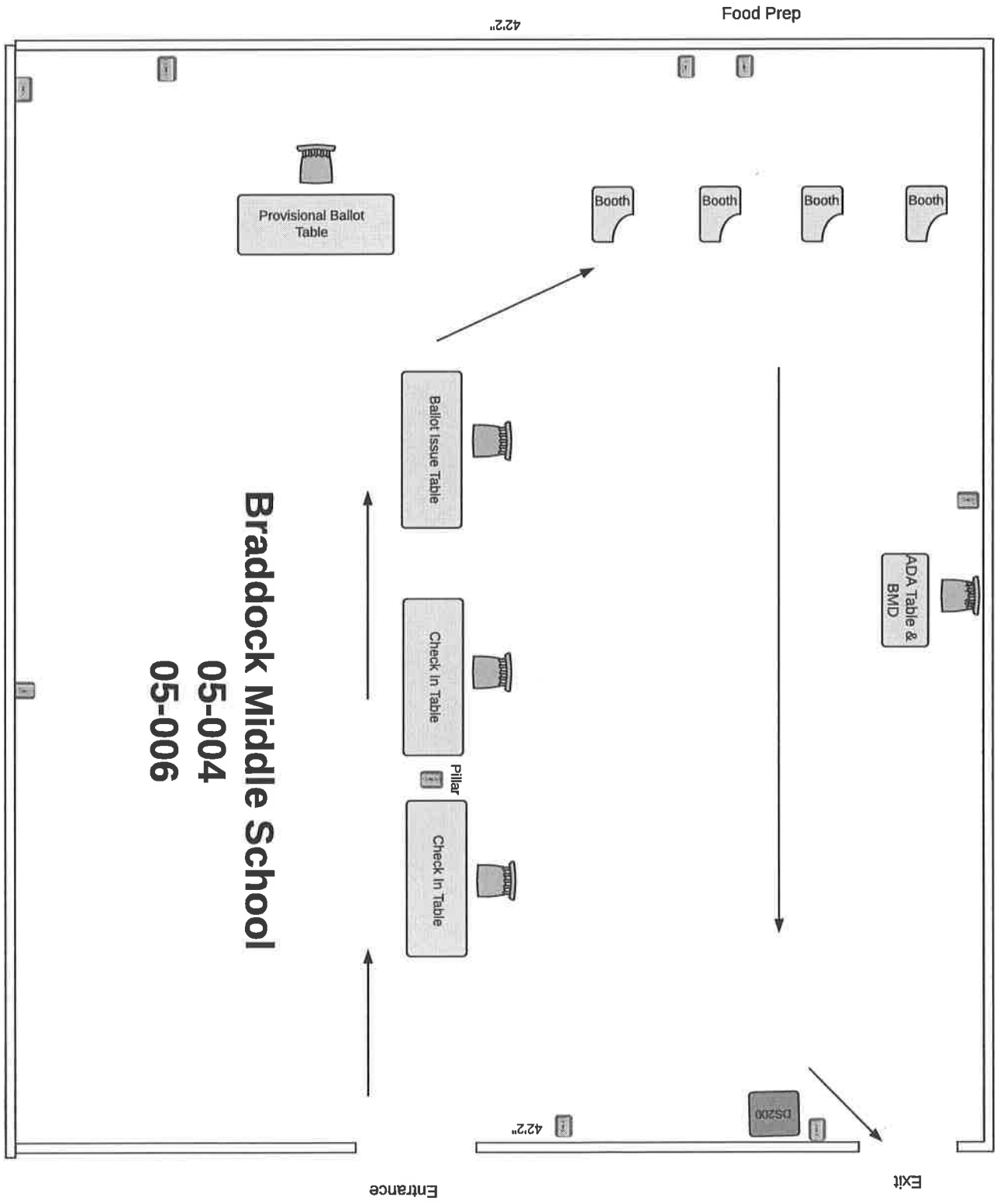

Consolidation Proposal for 2020 Presidential General Election

Consolidation of 006-001, 006-003, 006-005, 006-006

Combined Registration 4,221

80% Overall Turnout = 3,376 60% In Person Voting = 2,027 40% VBM = 1,350

Vote at Allegany County Multi-Purpose Building (006-006)

Voting Equipment

**4 Pollbooks
11 Voting Booths
2 BMDs
2 DS200s**

Election Judges

**2 Chief Judges
2 Check-in Judges
2 Ballot Issue Judges
2 Scanning Judges
5 Voting Judges**

District 006-001 – Active Registration 1,221

80% Overall Turnout = 977 60% In Person Voting = 587 40% VBM = 391

Voting Equipment

**2 Pollbooks
3 Voting Booths
1 BMD
1 DS200**

Election Judges

**2 Chief Judges
1 Ballot Issue Judge
1 Scanning Judge
2 Voting Judges**

District 006-003 – Active Registration 622

80% Overall Turnout = 498 60% In Person Voting = 299 40% VBM = 200

Voting Equipment

**2 Pollbooks
2 Voting Booths
1 BMD
1 DS200**

Election Judges

**2 Chief Judges
1 Ballot Issue Judge
1 Scanning Judge
2 Voting Judges**

District 006-005 – Active Registration 1,002

80% Overall Turnout = 802 60% In Person Voting = 482 40% VBM = 321

Voting Equipment

**2 Pollbooks
3 Voting Booths
1 BMD
1 DS200**

Election Judges

**2 Chief Judges
1 Ballot Issue Judge
1 Scanning Judge
2 Voting Judges**

District 006-006 – Active Registration 1,376

80% Overall Turnout = 1,101

60% In Person Voting = 661

40% VBM = 441

Voting Equipment

2 Pollbooks

4 Voting Booths

1 BMD

1 DS200

Election Judges

2 Chief Judges

1 Ballot Issue Judge

1 Scanning Judge

2 Voting Judges

Allegheny Multi Purpose Building

06-001

06-003

06-005

06-006

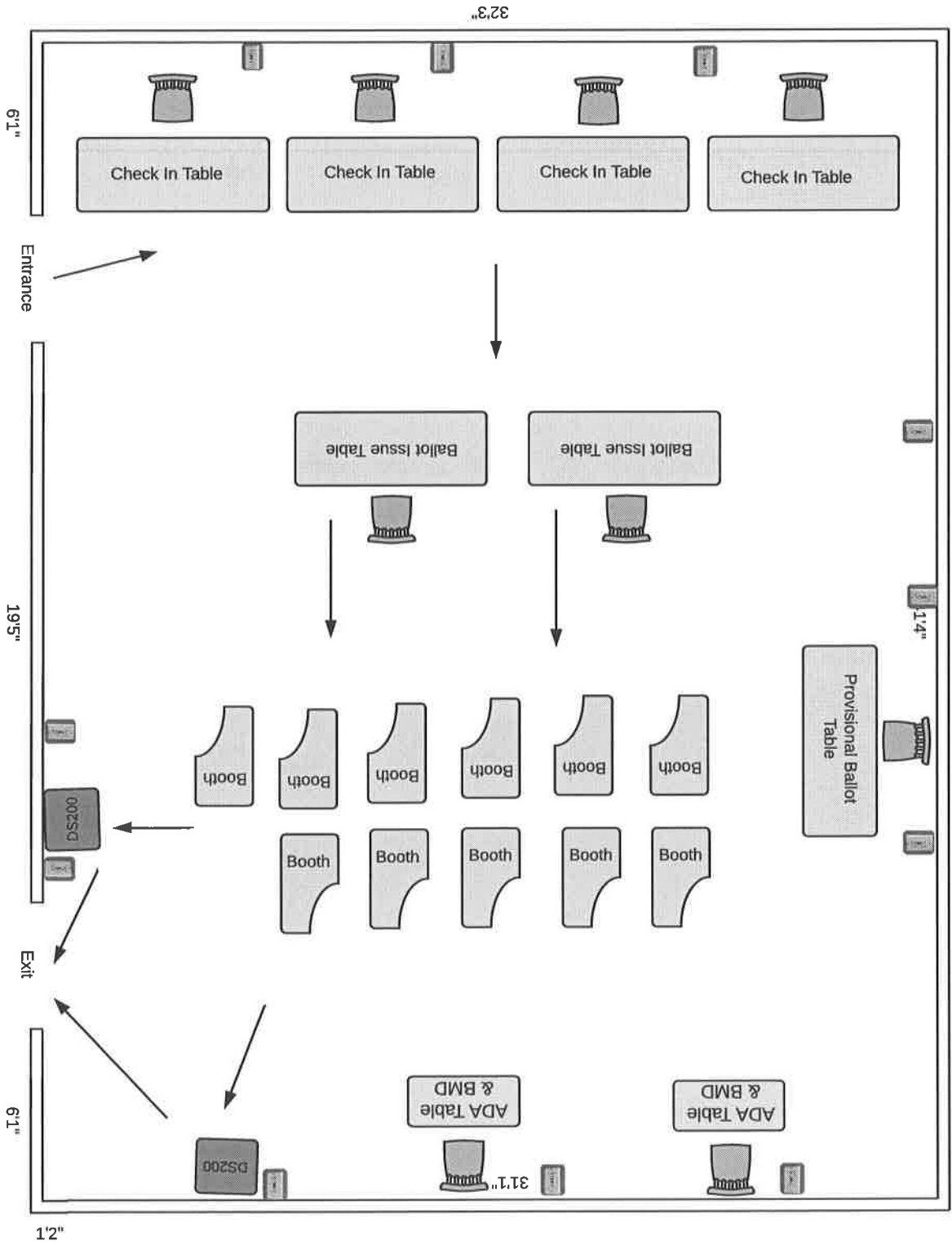

Consolidation of 007-001, 007-002, and 031-000

Combined Registration 4,158

80% Overall Turnout = 3,327 60% In Person Voting = 1,997 40% VBM = 1,331

Vote at Bel Air Elementary School - Gym (007-002)

Voting Equipment

**4 Pollbooks
10 Voting Booths
2 BMDs
2 DS200s**

Election Judges

**2 Chief Judges
2 Check-in Judges
2 Ballot Issue Judges
2 Scanning Judges
4 Voting Judges**

District 007-001 – Active Registration 1,509

80% Overall Turnout = 1,208 60% In Person Voting = 725 40% VBM = 484

Voting Equipment

**2 Pollbooks
4 Voting Booths
1 BMD
1 DS200**

Election Judges

**2 Chief Judges
1 Check-in Judge
1 Scanning Judge
2 Voting Judges**

District 007-002 – Active Registration 1,590

80% Overall Turnout = 1,272 60% In Person Voting = 764 40% VBM = 509

Voting Equipment

**2 Pollbooks
4 Voting Booths
1 BMD
1 DS200**

Election Judges

**2 Chief Judges
1 Ballot Issue Judge
1 Scanning Judge
2 Voting Judges**

District 031-000 – Active Registration 1,055

80% Overall Turnout = 844 60% In Person Voting = 507 40% VBM = 338

Voting Equipment

**2 Pollbooks
3 Voting Booths
1 BMD
1 DS200**

Election Judges

**2 Chief Judges
1 Ballot Issue Judge
1 Scanning Judge
2 Voting Judges**

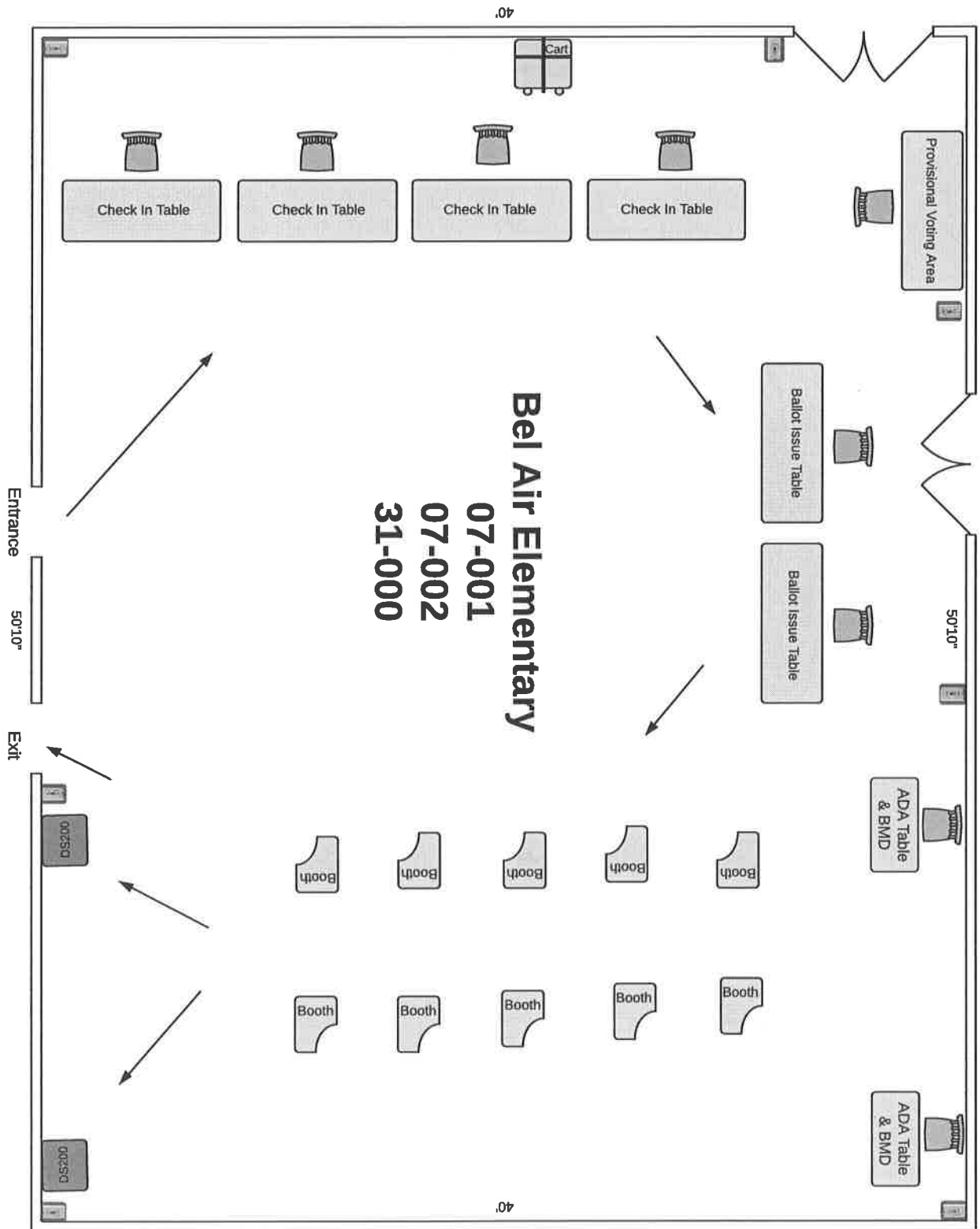

Consolidation of 009-000 and 010-000 - Combined Registration 2,086
80% Overall Turnout = 1,669 60% In Person Voting = 1,002 40% VBM = 668
Vote at Westmar Middle School – Lobby (010-000)

Voting Equipment

2 Pollbooks
6 Voting Booths
1 BMD
1 DS200

Election Judges

2 Chief Judges
1 Ballot Issue Judge
1 Scanning Judge
3 Voting Judges

District 009-000 – Active Registration 797
80% Overall Turnout = 638 60% In Person Voting = 383 40% VBM = 256

Voting Equipment

2 Pollbooks
2 Voting Booths
1 BMD
1 DS200

Election Judges

2 Chief Judges
1 Ballot Issue Judge
1 Scanning Judge
2 Voting Judges

District 010-000 – Active Registration 1,289
80% Overall Turnout = 1,032 60% In Person Voting = 620 40% VBM = 413

Voting Equipment

2 Pollbooks
4 Voting Booths
1 BMD
1 DS200

Election Judges

2 Chief Judges
1 Ballot Issue Judge
1 Scanning Judge
2 Voting Judges

Westmar Middle School
09-000
10-000

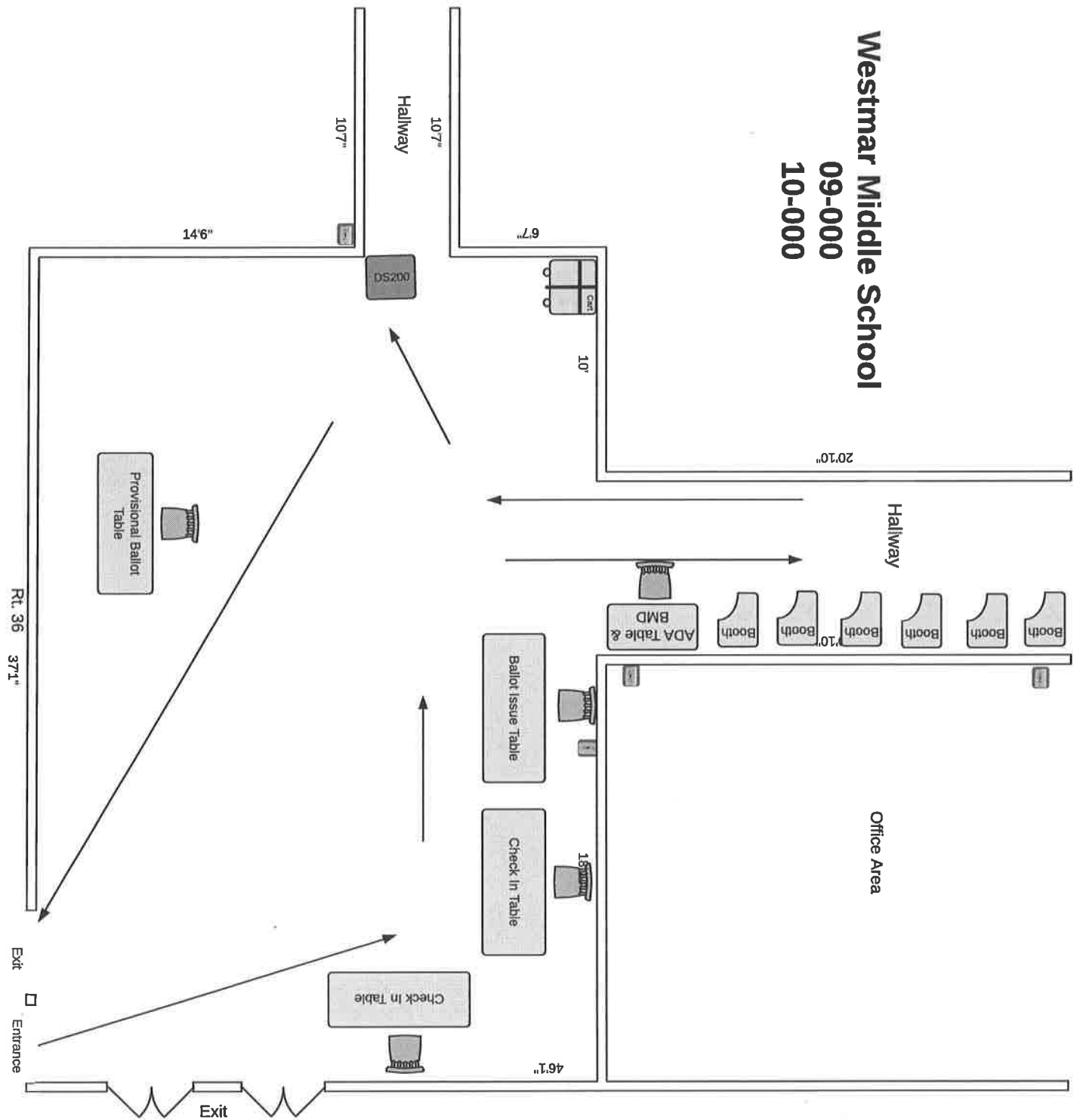

Consolidation of 029-001, 029-002, and 029-003

Combined Registration 4,476

80% Overall Turnout = 3,581 60% In Person Voting = 2,149 40% VBM = 1,433

Vote at LaVale Volunteer Fire Station #1 (029-001)

Voting Equipment

**5 Pollbooks
11 Voting Booths
2 BMDs
2 DS200s**

Election Judges

**2 Chief Judges
3 Check-in Judges
3 Ballot Issue Judges
2 Scanning Judges
5 Voting Judges**

District 029-001 – Active Registration 1,777

80% Overall Turnout = 1,422 60% In Person Voting = 854 40% VBM = 569

Voting Equipment

**2 Pollbooks
5 Voting Booths
1 BMD
1 DS200**

Election Judges

**2 Chief Judges
1 Ballot Issue Judge
1 Scanning Judge
2 Voting Judges**

District 029-002 – Active Registration 1,528

80% Overall Turnout = 1,223 60% In Person Voting = 734 40% VBM = 490

Voting Equipment

**2 Pollbooks
4 Voting Judges
1 BMD
1 DS200**

Election Judges

**2 Chief Judges
1 Ballot Issue Judge
1 Scanning Judge
2 Voting Judges**

District 029-003 – Active Registration 1,186

80% Overall Turnout = 949 60% In Person Voting = 570 40% VBM = 380

Voting Equipment

**2 Pollbooks
3 Voting Booths
1 BMD
1 DS200**

Election Judges

**2 Chief Judges
1 Ballot Issue Judge
1 Scanning Judge
2 Voting Judges**

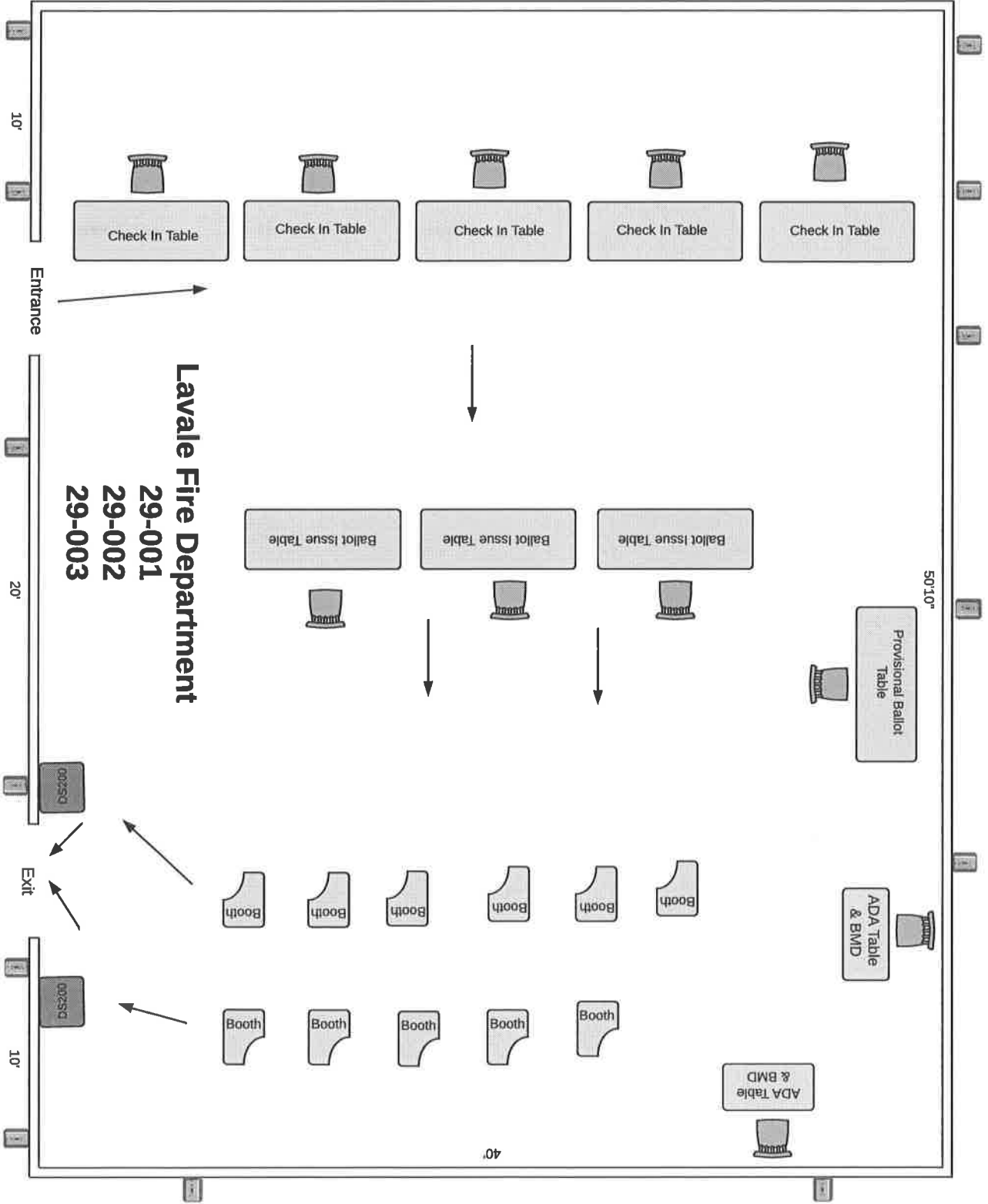

Lavale Fire Department
29-001
29-002
29-003

10'

20'

10'

50'10"

POLLING PLACES OF ALLEGANY COUNTY

Dist. 1	1-C	Flintstone Volunteer Fire Department – 21701 Flintstone Drive, NE – Flintstone
Dist. 2	1-C	Dept. of Emergency Services – 11400 PPG Road SE, - Cumberland
Dist. 3	1-C	Flintstone Volunteer Fire Department – 21701 Flintstone Drive, NE – Flintstone
Dist. 4 Prec. 2	1-C	Ft. Hill High School - 500 Greenway Avenue – Cumberland
Dist. 4 Prec. 3	1-C	Ft. Hill High School - 500 Greenway Avenue – Cumberland
Dist. 4 Prec. 4	1-C	Ft. Hill High School - 500 Greenway Avenue – Cumberland
Dist. 4 Prec. 5	1-C	Ft. Hill High School - 500 Greenway Avenue – Cumberland
Dist. 4 Prec. 8	1-C	Ft. Hill High School - 500 Greenway Avenue – Cumberland
Dist. 5 Prec. 4	1-B	Braddock Middle School - 909 Holland St. – Cumberland
Dist. 5 Prec. 6	1-B	Braddock Middle School - 909 Holland St. – Cumberland
Dist. 6 Prec. 1	1-C	Allegany County Multi-Purpose Building - 11490 Moss Ave., SW – Cumberland
Dist. 6 Prec. 3	1-C	Allegany County Multi-Purpose Building - 11490 Moss Ave., SW – Cumberland
Dist. 6 Prec. 5	1-C	Allegany County Multi-Purpose Building - 11490 Moss Ave., SW – Cumberland
Dist. 6 Prec. 6	1-B	Allegany County Multi-Purpose Building - 11490 Moss Ave., SW – Cumberland
Dist. 7 Prec. 1	1-B	Bel Air Elementary School - 14401 Barton Blvd., SW – Cumberland
Dist. 7 Prec. 2	1-A	Bel Air Elementary School - 14401 Barton Blvd., SW – Cumberland
Dist. 8	1-A	Westernport Elementary School - 172 Church St. – Westernport
Dist. 9	1-A	Westmar Middle School – 16915 Lower Georges Creek Rd., SW – Lonaconing
Dist. 10	1-A	Westmar Middle School – 16915 Lower Georges Creek Rd., SW – Lonaconing
Dist. 11	1-B	Frost Elementary School - 260 Shaw St. – Frostburg
Dist. 12	1-B	Mountain Ridge High School – Bus Entrance – 100 Dr. Nancy S. Grasmick La. – Frostburg
Dist. 13	1-B	Mt. Savage Elementary/Middle School - 13201 New School Rd., NW - Mt. Savage
Dist. 14	1-B	Ramada Inn – Allegany/Garrett Rm – 100 S. George St. - Cumberland
Dist. 16	1-C	Dept. of Emergency Services – 11400 PPG Road SE, - Cumberland
Dist. 18	1-B	Midland Fire Station - 20001 Union St., SW – Midland
Dist. 20	1-B	Ellerslie Volunteer Fire Department – 14200 Ellerslie Rd., NW – Ellerslie
Dist. 21	1-B	Flintstone Volunteer Fire Department – 21701 Flintstone Drive, NE – Flintstone
*Dist. 22 Prec. 1	1-C	Allegany College of MD - 12401 Willowbrook Rd SE, Continuing Education Bldg Room 14 – Cumberland
*Dist. 22 Prec. 2	1-B	Allegany College of MD - 12401 Willowbrook Rd SE, Continuing Education Bldg Room 14 – Cumberland
Dist. 23	1-B	St. Luke's Lutheran Church - 1601 Frederick St. – Cumberland
Dist. 24	1-B	Eckhart School - 17000 National Hwy, SW – Eckhart
Dist. 26	1-B	Frostburg Community Center - 27 Water St. – Frostburg
Dist. 29 Prec. 1	1-B	LaVale Volunteer Fire Department #1 - 421 National Hwy. – LaVale
Dist. 29 Prec. 2	1-B	LaVale Volunteer Fire Department #1 - 421 National Hwy. – LaVale
Dist. 29 Prec. 3	1-B	LaVale Volunteer Fire Department #1 - 421 National Hwy. – LaVale
Dist. 31	1-A	Bel Air Elementary School - 14401 Barton Blvd., SW – Cumberland
Dist. 34	1-B	Bedford Road Volunteer Fire Department - 13200 Bedford Rd., NE - Cumberland

EV01 – Early Voting Site Allegany County Office Complex – 701 Kelly Road, Room 100, Cumberland

*Consolidated precincts appear in bold type.

ANNE ARUNDEL COUNTY BOARD OF ELECTIONS

PUBLIC NOTICE - POLLING PLACE CHANGE TRACKER v1.0

2018 Election			2020 Election			Activity Log			
District / Precinct	Former Polling Location		# of Registered Voters	District / Precinct	Proposed New Location	# of Registered Voters	Reason for Change	Board Meeting Review Date	Board Action
01-006	St. Mark United Methodist Church	1440 Dorsey Road, Hanover, MD 21076	2624	01-006 / 022	Chesapeake Science Point Charter School 7321 Parkway Drive South, Hanover, MD 21076	8449	Election Judge Shortage - Consolidation.	August 4, 2020	Unanimously approved at August 4 Special Board Meeting
01-010	St. John Lutheran Church	300 Maple Road West, Linthicum, MD 21090	1368	01-002 / 010 / 011	Lindale MS 415 Andover Road, Linthicum, MD 21090	4234	Election Judge Shortage - Consolidation.	August 4, 2020	Unanimously approved at August 4 Special Board Meeting
01-011	Linthicum Library	400 Shipley Road, Linthicum, MD 21090	1159	01-002 / 010 / 011	Lindale MS 415 Andover Road, Linthicum, MD 21090	4234	Election Judge Shortage - Consolidation.	August 4, 2020	Unanimously approved at August 4 Special Board Meeting
01-013	Belle Grove ES	4502 Belle Grove Road, Baltimore, MD 21225	1136	01-013 / 017	Park ES 201 11th Avenue East, Baltimore, MD 21225	2583	Election Judge Shortage - Consolidation.	August 4, 2020	Unanimously approved at August 4 Special Board Meeting
02-007	Glen Burnie Baptist Church	7524 Old Stage Road, Glen Burnie, MD 21061	2811	02-003 / 007	Glen Burnie Park ES 500 Marlboro Road, Glen Burnie, MD 21061	4595	Election Judge Shortage - Consolidation.	August 4, 2020	Unanimously approved at August 4 Special Board Meeting
02-011	Woodside ES	160 Funke Road, Glen Burnie, MD 21061	1379	02-011 / 012	Glen Burnie Library 1010 Eastway, Glen Burnie, MD 21060	2995	Election Judge Shortage - Consolidation.	August 4, 2020	Unanimously approved at August 4 Special Board Meeting
02-020	Grace of God Fellowship	8302 Elvaton Road, Millersville, MD 21108	2198	02-002 / 020	Southgate ES 290 Shetlands Lane, Glen Burnie, MD 21061	3804	Election Judge Shortage - Consolidation.	August 4, 2020	Unanimously approved at August 4 Special Board Meeting
02-021	Heritage Community Church	8146 Quarterfield Road, Severn, MD 21144	3196	02-021 / 02-013	Old Mill HS 600 Patriot Lane, Millersville, MD 21108	4974	Election Judge Shortage - Consolidation.	August 4, 2020	Unanimously approved at August 4 Special Board Meeting
03-020	Emmanuel Lutheran Church	8615 Fort Smallwood Road, Pasadena, MD 21122	1766	03-020 / 03-003	High Point ES 7789 Edgewood Avenue, Pasadena, MD 21122	4765	Election Judge Shortage - Consolidation.	August 4, 2020	Unanimously approved at August 4 Special Board Meeting

ANNE ARUNDEL COUNTY BOARD OF ELECTIONS

2018 Election			2020 Election				Activity Log			
District / Precinct	Former Polling Location		# of Registered Voters	District / Precinct	Proposed New Location		# of Registered Voters	Reason for Change	Board Meeting Review Date	Board Action
03-022	Mt. Zion UMC	8178 Artic Drive, Pasadena, MD 21122	1764	03-022 / 03-017	Jacobsville ES	3801 Mountain Road, Pasadena, MD 21122	3760	Election Judge Shortage - Consolidation.	August 4, 2020	Unanimously approved at August 4 Special Board Meeting
03-023	Earleigh Heights VFD	161 Ritchie Highway, Severna Park, MD 21146	1711	03-023 / 03-009	Pasadena ES	401 Pasadena Road, Pasadena, MD 21122	2778	Election Judge Shortage - Consolidation.	August 4, 2020	Unanimously approved at August 4 Special Board Meeting
03-024	Orchard Beach VFD	7549 Solley Road, Glen Burnie, MD 21060	2430	03-024 / 03-001 / 03-016	Northeast HS	1121 Duvall Highway, Pasadena, MD 21122	6692	Election Judge Shortage - Consolidation.	August 4, 2020	Unanimously approved at August 4 Special Board Meeting
04-006	Community UMC	300 Brock Bridge Road, Laurel, MD 20724	3001	04-006 / 04-001	Maryland City ES	3359 Crumpton South, Laurel, MD 20724	5081	Election Judge Shortage - Consolidation.	August 4, 2020	Unanimously approved at August 4 Special Board Meeting
04-010	First Baptist Church of Crofton	1690 Crofton Parkway, Crofton, MD 21114	1385	04-010 / 07-018	Carver Staff Development Center	2671 Carver Road, Gambrills, MD 21054	3603	Election Judge Shortage - Consolidation.	August 4, 2020	Unanimously approved at August 4 Special Board Meeting
04-011	O'Malley Senior Center	1275 Odenton Road, Odenton, MD 21113	1883	04-011 / 04-003 / 04-013	Arundel HS	1001 Annapolis Road, Gambrills, MD 21054	5643	Election Judge Shortage - Consolidation.	August 4, 2020	Unanimously approved at August 4 Special Board Meeting
04-012	Odenton Baptist Church	8410 Piney Orchard Parkway, Odenton, MD 21113	1987	04-012 / 04-026	Odenton Library	1325 Annapolis Road, Odenton, MD 21113	2961	Election Judge Shortage - Consolidation.	August 4, 2020	Unanimously approved at August 4 Special Board Meeting
04-013	Arundel MS	1179 Hammond Lane, Odenton, MD 21113	1826	04-013 / 04-003 / 04-011	Arundel HS	1001 Annapolis Road, Gambrills, MD 21054	5643	Election Judge Shortage - Consolidation.	August 4, 2020	Unanimously approved at August 4 Special Board Meeting
04-015	Herald Harbor Community Center	390 Hall Road, Crownsville, MD 21032	2785	04-015 / 04-004	Millersville ES	1601 Millersville Road, Millersville, MD 21108	5000	Election Judge Shortage - Consolidation.	August 4, 2020	Unanimously approved at August 4 Special Board Meeting
04-018	Faith Community Church	1306 Riedel Road, Gambrills, MD 21054	2763	04-018 / 04-021	Nantucket ES	2350 Nantucket Drive, Crofton, MD 21114	6068	Election Judge Shortage - Consolidation.	August 4, 2020	Unanimously approved at August 4 Special Board Meeting

ANNE ARUNDEL COUNTY BOARD OF ELECTIONS

2018 Election			2020 Election				Activity Log			
District / Precinct	Former Polling Location		# of Registered Voters	District / Precinct	Proposed New Location	# of Registered Voters	Reason for Change	Board Meeting Review Date	Board Action	
04-020	Piney Orchard Community Center	2400 Stream Valley Drive, Odenton, MD 21113	2095	04-020 / 04-023	Waugh Chapel ES	840 Sunflower Drive, Odenton, MD 21113	5403	Election Judge Shortage - Consolidation.	August 4, 2020	Unanimously approved at August 4 Special Board Meeting
05-001	St. Margaret's Episcopal Church	1601 Pleasant Plains Road, Annapolis, MD 21409	2392	05-001 / 05-018 / 05-020 / 05-022 / 05-028	Broadneck HS	1265 Green Holly Drive, Annapolis, MD 21409	9736	Election Judge Shortage - Consolidation.	August 4, 2020	Unanimously approved at August 4 Special Board Meeting
05-003	Arnold Senior Center	44 Church Road, Arnold, MD 21012	2084	05-003 / 05-011	Magothy River MS	241 Peninsula Farm Road, Arnold, MD 21012	3986	Election Judge Shortage - Consolidation.	August 4, 2020	Unanimously approved at August 4 Special Board Meeting
05-009	Folger McKinsey ES	175 Arundel Beach Road, Severna Park, MD 21146	1312	05-009 / 05-010 / 05-012 / 05-031 / 05-032 / 05-034	Severna Park HS	60 Robinson Road, Severna Park, MD 21146	6736	Election Judge Shortage - Consolidation.	August 4, 2020	Unanimously approved at August 4 Special Board Meeting
05-010	Woods Memorial Church	611 Baltimore Annapolis Blvd, Severna Park, MD 21146	1096	05-010 / 05-009 / 05-012 / 05-031 / 05-032 / 05-034	Severna Park HS	60 Robinson Road, Severna Park, MD 21146	6736	Election Judge Shortage - Consolidation.	August 4, 2020	Unanimously approved at August 4 Special Board Meeting
05-017	Cape St. Claire Improvement Assoc.	1223 River Bay Road, Annapolis, MD 21409	2287	05-017 / 05-002	Cape St. Claire ES	931 Blue Ridge Drive, Annapolis, MD 21409	4840	Election Judge Shortage - Consolidation.	August 4, 2020	Unanimously approved at August 4 Special Board Meeting
05-020	Gloria Dei Lutheran Church	461 College Parkway, Arnold, MD 21012	2055	05-020 / 05-001 / 05-018 / 05-022 / 05-028	Broadneck HS	1265 Green Holly Drive, Annapolis, MD 21409	9736	Election Judge Shortage - Consolidation.	August 4, 2020	Unanimously approved at August 4 Special Board Meeting
05-021	CrossPointe Church	365 Jones Station Road, Arnold, MD 21012	2834	05-021 / 05-016	Severn River MS	241 Peninsula Farm Road, Arnold, MD 21012	4346	Election Judge Shortage - Consolidation.	August 4, 2020	Unanimously approved at August 4 Special Board Meeting
05-028	Windsor Farm ES	591 Broadneck Road, Annapolis, MD 21409	1024	05-028 / 05-001 / 05-018 / 05-020 / 05-022	Broadneck HS	1265 Green Holly Drive, Annapolis, MD 21409	9736	Election Judge Shortage - Consolidation.	August 4, 2020	Unanimously approved at August 4 Special Board Meeting
05-029	Christ Lutheran Church	8249 Jumpers Hole Road, Millersville, MD 21108	897	05-029 / 05-019 / 05-024 / 05-030	Severna Park MS	450 Jumpers Hole Road, Severna Park, MD 21146	5389	Election Judge Shortage - Consolidation.	August 4, 2020	Unanimously approved at August 4 Special Board Meeting

ANNE ARUNDEL COUNTY BOARD OF ELECTIONS

2018 Election			2020 Election				Activity Log			
District / Precinct	Former Polling Location		# of Registered Voters	District / Precinct	Proposed New Location	# of Registered Voters	Reason for Change	Board Meeting Review Date	Board Action	
05-030	Pasadena UMC	61 Ritchie Highway, Pasadena, MD 21122	1120	05-030 / 05-019 / 05-024 / 05-029	Severna Park MS	450 Jumpers Hole Road, Severna Park, MD 21146	5389	Election Judge Shortage - Consolidation.	August 4, 2020	Unanimously approved at August 4 Special Board Meeting
05-031	Woods Memorial Church	611 Baltimore Annapolis Blvd, Severna Park, MD 21146	668	05-031 / 05-009 / 05-010 / 05-012 / 05-032 / 05-034	Severna Park HS	60 Robinson Road, Severna Park, MD 21146	6736	Election Judge Shortage - Consolidation.	August 4, 2020	Unanimously approved at August 4 Special Board Meeting
05-034	Asbury Town-Neck UMC	429 Asbury Drive, Severna Park, MD 21146	1230	05-034 / 05-009 / 05-010 / 05-012 / 05-031 / 05-032	Severna Park HS	60 Robinson Road, Severna Park, MD 21146	6736	Election Judge Shortage - Consolidation.	August 4, 2020	Unanimously approved at August 4 Special Board Meeting
05-035	Gloria Dei Lutheran Church	461 College Parkway, Arnold, MD 21012	192	05-035 / 05-027	Broadneck Library	1275 Green Holly Drive, Annapolis, MD 21409	2109	Election Judge Shortage - Consolidation.	August 4, 2020	Unanimously approved at August 4 Special Board Meeting
06-004	Heritage Baptist Church	1740 Forest Drive, Annapolis, MD 21401	737	06-004 / 06-005 / 06-009 / 06-014	Annapolis MS	1399 Forest Drive, Annapolis, MD 21403	6197	Election Judge Shortage - Consolidation.	August 4, 2020	Unanimously approved at August 4 Special Board Meeting
06-008	Eastport VFD	914 Bay Ridge Avenue, Annapolis, MD 21403	1777	06-008 / 06-006 / 06-015 / 06-016	Pip Moyer Rec. Center	273 Hilltop Lane, Annapolis, MD 21403	5760	Election Judge Shortage - Consolidation.	August 4, 2020	Unanimously approved at August 4 Special Board Meeting
06-010	United Church of Christ	8 Carvel Circle, Edgewater, MD 21037	1617	06-010 / 06-019 / 06-020 / 06-026 / 06-028	Annapolis HS	2700 Riva Road, Annapolis, MD 21401	10787	Election Judge Shortage - Consolidation.	August 4, 2020	Unanimously approved at August 4 Special Board Meeting
06-013	Mills-Parole ES	1 George and Marion Phelps Lane, Annapolis, MD 21401	1299	06-013 / 06-003 / 06-029	Phoenix Academy	1411 Cedar Park Road, Annapolis, MD 21401	4038	Election Judge Shortage - Consolidation.	August 4, 2020	Unanimously approved at August 4 Special Board Meeting
06-014	American Legion Post #141	1707 Forest Drive, Annapolis, MD 21401	2261	06-014 / 06-004 / 06-005 / 06-009	Annapolis MS	1399 Forest Drive, Annapolis, MD 21403	6197	Election Judge Shortage - Consolidation.	August 4, 2020	Unanimously approved at August 4 Special Board Meeting
06-015	Salvation Army - Annapolis	351 Hilltop Lane, Annapolis, MD 21403	1604	06-015 / 06-006 / 06-008 / 06-016	Pip Moyer Rec. Center	273 Hilltop Lane, Annapolis, MD 21403	5760	Election Judge Shortage - Consolidation.	August 4, 2020	Unanimously approved at August 4 Special Board Meeting

ANNE ARUNDEL COUNTY BOARD OF ELECTIONS

2018 Election			2020 Election				Activity Log			
District / Precinct	Former Polling Location		# of Registered Voters	District / Precinct	Proposed New Location	# of Registered Voters	Reason for Change	Board Meeting Review Date	Board Action	
06-016	Eastport Community Center	1014 President Street, Annapolis, MD 21403	1147	06-016 / 06-006 / 06-008 / 06-015	Pip Moyer Rec. Center	273 Hilltop Lane, Annapolis, MD 21403	5760	Election Judge Shortage - Consolidation.	August 4, 2020	Unanimously approved at August 4 Special Board Meeting
06-020	American Legion Post #7	1905 Crownsville Road, Annapolis, MD 21401	1462	06-020 / 06-010 / 06-019 / 06-026 / 06-028	Annapolis HS	2700 Riva Road, Annapolis, MD 21401	10787	Election Judge Shortage - Consolidation.	August 4, 2020	Unanimously approved at August 4 Special Board Meeting
06-022	Weems Creek Baptist Church	600 N Bestgate Road, Annapolis, MD 21401	2283	06-022 / 06-002	Germantown ES	200 Windell Avenue, Annapolis, MD 21401	4189	Election Judge Shortage - Consolidation.	August 4, 2020	Unanimously approved at August 4 Special Board Meeting
06-025	Bay Ridge Civic Association	80 E Lake Drive, Annapolis, MD 21403	1722	06-025 / 06-024	Hillsmere ES	3052 Arundel On The Bay Road, Annapolis, MD 21403	3463	Election Judge Shortage - Consolidation.	August 4, 2020	Unanimously approved at August 4 Special Board Meeting
06-027	South Shore Baptist Church	725 Herald Harbor Road, Crownsville, MD 21032	1025	06-027 / 04-014	South Shore ES	1376 Fairfield Loop Road, Crownsville, MD 21032	3463	Election Judge Shortage - Consolidation.	August 4, 2020	Unanimously approved at August 4 Special Board Meeting
06-028	Bay Area Community Church	884 Chesterfield Road, Annapolis, MD 21401	1768	06-028 / 06-010 / 06-019 / 06-020 / 06-026	Annapolis HS	2700 Riva Road, Annapolis, MD 21401	10787	Election Judge Shortage - Consolidation.	August 4, 2020	Unanimously approved at August 4 Special Board Meeting
06-029	Weems Creek Baptist Church	600 N Bestgate Road, Annapolis, MD 21401	1175	06-029 / 06-003 / 06-013	Phoenix Academy	1411 Cedar Park Road, Annapolis, MD 21401	4038	Election Judge Shortage - Consolidation.	August 4, 2020	Unanimously approved at August 4 Special Board Meeting
06-030	Bay Ridge Christian Church	1071 Bay Ridge Road, Annapolis, MD 21403	1875	06-030 / 06-007 / 06-017	Georgetown East ES	111 Dogwood Road, Annapolis, MD 21403	5051	Election Judge Shortage - Consolidation.	August 4, 2020	Unanimously approved at August 4 Special Board Meeting
06-031	St. Philips Episcopal Church	730 Bestgate Road, Annapolis, MD 21401	1549	06-031 / 06-021 / 06-032	Rolling Knolls ES	1985 Valley Road, Annapolis, MD 21401	4221	Election Judge Shortage - Consolidation.	August 4, 2020	Unanimously approved at August 4 Special Board Meeting
07-012	Riva VFD	3123 Riva Road, Riva, MD 21140	1315	07-012 / 07-005 / 07-006	South River HS	201 Central Avenue East, Edgewater, MD 21037	8254	Election Judge Shortage - Consolidation.	August 4, 2020	Unanimously approved at August 4 Special Board Meeting

ANNE ARUNDEL COUNTY BOARD OF ELECTIONS

2018 Election			2020 Election				Activity Log			
District / Precinct	Former Polling Location		# of Registered Voters	District / Precinct	Proposed New Location		# of Registered Voters	Reason for Change	Board Meeting Review Date	Board Action
07-013	Arundel VFD	2374 Davidsonville Road, Gambrills, MD 21054	2338	07-013 / 07-017	Crofton MS	2301 Davidsonville Road, Gambrills, MD 21054	3577	Election Judge Shortage - Consolidation.	August 4, 2020	Unanimously approved at August 4 Special Board Meeting
07-023	South County Senior Center	27 Stepneys Lane, Edgewater, MD 21037	2876	07-023 / 07-027	Central MS	221 Central Avenue East, Edgewater, MD 21037	6010	Election Judge Shortage - Consolidation.	August 4, 2020	Unanimously approved at August 4 Special Board Meeting



Carroll County Board of Elections



300 South Center Street, Room 212 Westminster, MD 21157-5366

410-386-2080

MD RELAY: Call 711 or 800-735-2258 (TTY)

Toll Free: 1-888-302-8978

ccboe@carrollcountymd.gov

elections.carrollcountymd.gov

FAX: 410-876-3925

To: Maryland State Board of Elections

From: Katherine Berry, Election Director

Date: July 18, 2020

Re: Request for precinct consolidation approval

At its July 2020 Carroll County board meeting, the members of the board voted unanimously to move forward with consolidation of the two precincts that were previously assigned in assisted living facilities. They are requesting formal approval from the State Board so that preparations for the Presidential General Election can move forward. **Precinct 5006 - Fairhaven will move to 5001-Sykesville Middle School and 7005 – Carroll Lutheran Village will move to 7007 Westminster Elementary School.** The proposed locations are already established polling places, so they have met all of the criteria to add more voters to these locations.

Thank you for your consideration.

Katherine Berry

Election Director

Katherine.berry@maryland.gov

(410)386-2958

Polling Place Changes

At its August 6, 2020 at 9 a.m. meeting, the Charles County Board of Elections will consider consolidating the following polling locations to accommodate the lack of election judges and loss of polling locations:

Consolidate	Consolidate with (voting location)
1-1 Mary H. Matula Elementary School 6025 Radio Station Road La Plata, MD 20646	1-4 LaPlata High School - Gym 6035 Radio Station Road La Plata, MD 20646
1-2 Milton M. Somers Middle School 300 Willow Lane La Plata, MD 20646	1-3 Walter J. Mitchell Elementary School - Gym 400 Willow Lane La Plata, MD 20646
6-19 Theodore G. Davis Middle School 2495 Davis Road Waldorf, MD 20603 and 6-21 William A. Diggs Elementary School 2615 Davis Road Waldorf, MD 20603	6-3 North Point High School – Gym 2500 Davis Road Waldorf, MD 20603
6-14 Robert D. Stethem Educational Center 7775 Marshall Corner Road Pomfret, MD 20675	6-1 McDonough High School 7165 Marshall Corner Road Pomfret, MD 20675
6-15 Lancaster Neighborhood Center 4150 Lancaster Circle Waldorf, MD 20603	6-20 C. Paul Barnhart Elementary School 4800 Lancaster Circle Waldorf, MD 20603
6-11 Berry Elementary School 10155 Berry Road Waldorf, MD 20603	6-13 Mattawoman Middle School 10145 Berry Road Waldorf, MD 20603
8-5 St. Mary's School Bryantown 13715 Notre Dame Place Bryantown, MD 20617	8-1 T.C. Martin Elementary School 5315 Olivers Shop Road Bryantown, MD 20617
6-4 William B. Wade Elementary School 2300 Smallwood Drive West Waldorf, MD 20603	6-10 Westlake High School 3300 Middletown Road Waldorf, MD 20603
6-17 Wakefield Neighborhood Center 2002 Nantucket Driver Waldorf, MD 20602	6-8 Benjamin Stoddert Middle School 2040 St. Thomas Drive Waldorf, MD 20602
6-9 Sheffield Neighborhood Center 12146 Pawtucket Lane Waldorf, MD 20602	6-18 Mary B. Neal Elementary School 12105 St. George's Drive Waldorf, MD 20602
6-6 Dr. Gustavus Brown Elementary School 421 University Drive	6-7 Dr. Samuel A. Mudd Elementary School (Café) 820 Stone Avenue

Waldorf, MD 20602	Waldorf, MD 20602
7-4 J.C. Parks Elementary School 3505 Livingston Road Indian Head, MD 20640	7-3 Matthew Henson Middle School 3535 Livingston Road Indian Head, MD 20640
8-3 Trinity Baptist Church Hall 2671 Mattawoman-Beantown Road Waldorf, MD 20601	8-2 – New Thomas Stone High School (Café) 3785 Leonardtown Road Waldorf, MD 20601
6-22 Waldorf Elk's Lodge 2210 Old Washington Road Waldorf, MD 20601	6-12 John Hanson Middle School 12350 Vivian Adams Drive Waldorf, MD 20601
6-16 Dorchester Neighborhood Center 5005 Dorchester Circle Waldorf, MD 20601	6-2 Billingsley Elementary School 10069 Billingsley Road White Plains, MD 20695

Unavailable sites

9-1 Hughesville Firehouse 15245 Prince Frederick Road Hughesville, MD 20637	9-1 American Legion Post 238 6265 Brandywine Road Hughesville, MD 20637
8-2 St. Peter's School 3320 St. Peter's Drive Waldorf, MD 20601	8-2 Thomas Stone High School (Café) 3785 Leonardtown Road Waldorf, MD 20601

Temporary Early Voting Site Change for 2020 General (due to size)

From	To
St. Charles Gleneagles Neighborhood Center 4900 Kirkcaldy Court Waldorf, MD 20602	St. Charles High School (Gym) 5305 Piney Church Road Waldorf, MD 20602

The meeting is open to the public and will be held virtually. Please call the Director at 301-934-8972 for the call in information by 4:30 August 5, 2020.

PROPOSED FREDERICK COUNTY PRECINCT CONSOLIDATIONS – 2020 GENERAL ELECTION

Unavailable Early Voting Centers/Polling Places

Early Voting – Frederick Senior Center

01-003 – Point of Rocks Community Center

02-003 – Evangelical Lutheran Church

07-005/6 – St. Ignatius Catholic Church

17-001 – Johnsville Methodist Church

21-001/7 – Brook Hill United Methodist Church

PRECINCTS 01-001, 01-002, 01-003 – Tuscarora High School

Total Registration – 9,177

Voters affected – 4,868

PRECINCTS 02-001, 02002 – Lincoln ES (unchanged)

Total Registration – 4,349

PRECINCTS 02-003, 02-005 – Talley Recreation Center

Total Registration – 7,239

Voters affected – 3,297

PRECINCT 02-004 – Hillcrest ES (unchanged)

Total Registration – 4,484

PRECINCTS 02-006, 02-014, 02-016 – Crestwood Middle

Total Registration – 7,222

Voters affected – 4,986

PRECINCTS 02-007, 02-011, 02-018 – Governor Thomas Johnson HS

Total Registration – 8,361

Voters affected – all

PRECINCT 02-008 – Waverley ES (unchanged)

Total Registration – 4,282

PRECINCT 02-010 – Monocacy Middle (unchanged)

Total Registration – 4,442

PRECINCTS 02-013, 02-017 – Cornerstone Fellowship Church (unchanged)

Total Registration – 5,319

PRECINCT 02-015 – Monocacy ES (unchanged)

Total Registration – 4,591

PRECINCTS 03-001, 03-002, 03-003 – Middletown VFD Activities Center

Total Registration – 8,057

Voters affected – all

PRECINCTS 04-001, 11-001, 17-001 – Woodsboro ES

Total Registration – 4,752

Voters affected – 2,407

PRECINCT 05-001 – Emmitsburg ES (unchanged)

Total Registration – 3,512

PRECINCTS 06-001, 16-001 – Myersville ES

Total Registration – 4,936

Voters affected – 1,613

PRECINCTS 07-001, 07-004, 07-007 – Sugarloaf ES

Total Registration – 5,754

Voters affected – 3,395

PRECINCT 07-002 – Centerville ES (unchanged)

Total Registration – 4,917

PRECINCTS 07-003, 07-005 – Urbana HS

Total Registration – 2,800

Voters affected – 93

PRECINCTS 08-001, 19-001 – Liberty ES

Total Registration – 3,247

Voters affected – 1,388

PRECINCTS 09-001, 09-005 – New Market Middle

Total Registration – 4,787

Voters affected – 1,543

PRECINCT 09-002 – Green Valley ES (unchanged)

Total Registration – 4,551

PRECINCTS 09-003, 09-006, 09-008, 09-009 – Oakdale HS

Total Registration – 7,062

Voters affected – all

PRECINCT 09-004 – Kemptown ES (unchanged)

Total Registration – 3,747

PRECINCT 09-007 – Deer Crossing ES (unchanged)

Total Registration – 5,026

PRECINCTS 10-001, 15-001, 15-002 – Catoctin HS

Total Registration – 7,787

Voters affected - all

PRECINCTS 12-001, 12-002, 22-001, 22-002 – Faith Baptist Church

Total Registration – 4,287

Voters affected – 1,199

PRECINCTS 13-001, 13-002, 13-003 – Mt. Pleasant Ruritan Club (unchanged)

Total Registration – 5,239

PRECINCTS 14-001, 14-002 – Jefferson Ruritan

Total Registration – 4,006

Voters affected – 504

PRECINCT 18-001 – Twin Ridge ES (unchanged)

Total Registration – 3,319

PRECINCTS 18-002, 18-003 – Damascus Road Community Church

Total Registration – 4,185

Voters affected – 2,637

PRECINCT 20-001 – Lewistown ES (unchanged)

Total Registration – 2,267

PRECINCTS 21-001, 21-003, 21-004, 21-007 – Yellow Springs ES

Total Registration – 6,958

Voters affected – 2,530

PRECINCTS 21-002, 21-008 - Whittier ES (unchanged)

Total Registration – 1,898

PRECINCTS 23-001, 23-002 – Orchard Grove ES (unchanged)

Total Registration – 5,228

PRECINCTS 24-001, 24-003 – Church of the Transfiguration

Total Registration – 2,489

Voters affected – 581

PRECINCTS 24-002, 24-004, 24-005, 24-006 – People’s Baptist Church (unchanged)

Total Registration – 1,991

PRECINCT 25-001 – Brunswick Middle (unchanged)

Total Registration – 3,628

PRECINCTS 26-001, 26-002 – Walkersville HS

Total Registration – 6,857

Voters affected – 3,676

POLLING PLACES BEFORE CONSOLIDATION – 63

POLLING PLACES AFTER CONSOLIDATION – 37

TOTAL VOTERS AFFECTED – 65,984

ELECTION OFFICE

Cynthia L. Remmey
Director

Kimberley H. Slusar
Deputy Director



ELECTION BOARD

Allison W. McCord, President
Joseph N. Price, Vice President
Julia A. Bopst, Secretary
Medford J. Campbell III, Member
Michael A. Dykes, Member
Brian K. Young, Esq., Board Counsel

To: Maryland State Board of Elections

From: Kimberley H. Slusar, Deputy Director

Date: August 3, 2020

Re: Request for precinct consolidation approval

At the July 31, 2020 Harford County Board Meeting, the members of the Board voted unanimously to move forward with consolidating precincts. They are requesting formal approval from the State Board so that preparations for the Presidential General Election can move forward. Harford County has 63 precincts and will be consolidating them into 34 precincts for the November General Election.

Thank you for your consideration,

A handwritten signature in blue ink that reads "Kimberley H. Slusar".

Kimberley H. Slusar

Deputy Director

Kim.slusar@maryland.gov

410-638-3565

63 polling places

Precinct	Voter Count	Polling Place Name	Address
LOAD 1 (Truck 1's 1st load at Bay 4)	25273	Bel Air Region (1)	
3-14	2726	Bel Air High School	100 Heighe Street, Bel Air, 21014
3-12	2254	Bel Air Middle School	99 Idlewild Street, Bel Air, 21014
3-17	2482	Wakefield Elementary School	900 S. Main Street, Bel Air, 21014
3-16	2444	Ring Factory Elementary School	1400 Emmorton Road, Bel Air, 21014
3-10	3032	Bel Air Elementary School	30 E. Lee Street, Bel Air, 21014
3-11	1964	Mt. Ararat Lodge	136 E Gordon Street, Bel Air, 21014
3-04	1730	Hickory Elementary School	2100 Conowingo Road, Bel Air, 21014
3-20	2523	Prospect Mill Elementary School	101 Prospect Mill Road, Bel Air, 21015
3-22	3447	Harford Technical High School	200 Thomas Run Road, Bel Air, 21015
3-02	2671	Churchville Recreation Center	3023 Level Road, Churchville, 21028
LOAD 2 (Truck 2's 1st load at Bay 2)	29586	Fallston/Forest Hill Region	
4-05	3435	Roni Chenowith Activity Center	1701 Fallston Road, Fallston, 21047
4-02	2704	Youths Benefit Elementary School	1901 Fallston Road, Fallston, 21047
3-06	3119	Fallston Middle School	2303 Carrs Mill Road, Fallston, 21047
3-03	3787	Fallston High School	2301 Carrs Mill Road, Fallston, 21047
3-13	3096	Red Pump Elementary School	600 Red Pump Road, Bel Air, 21014
3-23	3162	St. Matthew Lutheran Church	1200 Churchville Road, Bel Air, 21014
3-09	3360	Forest Lakes Elementary School	100 Osborne Parkway, Forest Hill, 21050
3-24	2451	Victorious Faith Fellowship	106 Rock Spring Church Road, Forest Hill, 21050
3-05/3-26	4472	Forest Hill Elementary School	2407 Rocks Road, Forest Hill, 21050
LOAD 3 (Truck 1's 2nd load at Bay 4)	21781	Edgewood/Joppatowne Region	
1-06	3213	Edgewood Recreation Center	1980 Brookside Drive, Edgewood, 21040
1-19	2888	Edgewood High School	2415 Willoughby Beach Road, Edgewood 21040
1-05	2435	Deerfield Elementary School	2307 Willoughby Beach Road, Edgewood, 21040
1-03	1830	Edgewood Elementary School	2100 Cedar Drive, Edgewood, 21040
1-01	3352	Magnolia Elementary School	901 Trimble Road, Joppa, 21085
1-24/1-41	2390	Riverside Elementary School	211 Stillmeadow Drive, Joppa 21085
1-45	2558	Joppatowne High School	555 Joppa Farm Road, Joppa, 21085
1-04/1-23	3115	Joppatowne Elementary School	407 Trimble Road, Joppa, 21085
LOAD 4 (Truck 2's 2nd load at Bay 2)	27746	Abingdon Region	
2-03	1793	Aberdeen VFW	821 Old Philadelphia Road, Aberdeen, 21001
1-20	3681	Riverside Community Center	1 Church Creek Road, Belcamp, 21017
1-16	3034	Church Creek Elementary School	4299 Church Creek Road, Belcamp, 21017
1-12	3071	Abingdon Fire Hall	3306 Abingdon Road, Abingdon, 21009
1-11	2845	William S. James Elementary School	1 Laurentum Parkway, Abingdon, 21009
1-09	2488	Abingdon Library	2510 S.Tollgate Road, Abingdon, 21009
1-15	2894	Abingdon Elementary School	399 Singer Road, Abingdon, 21009
1-08	3846	Emmorton Elementary School	2502 S.Tollgate Road, Bel Air, 21015
1-14	4094	Patterson Mill Middle/High School	65 Patterson Mill Road, Bel Air, 21015
LOAD 5 (Truck 1's only load at Bay 4)	20052	Northern Harford County	
4-03	2732	Norrisville Elementary School	5302 Norrisville Road, White Hall, 21161
4-01/4-07	3245	Jarrettsville Elementary School	3818 Norrisville Road, Jarrettsville, 21084
4-06	2076	Jarrettsville Fire Hall	3825 Federal Hill Road, Jarrettsville, 21084
4-04	2794	North Bend Elementary School	1445 North Bend Road, Jarrettsville, 21084
5-03	2709	North Harford Elementary School	120 Pylesville Road, Pylesville, 21132
5-02	2385	North Harford High School	211 Pylesville Road, Pylesville, 21132
5-01	2556	Dublin Elementary School	1527 Whiteford Road, Street, 21154
5-04	1555	Darlington Elementary School	2119 Shuresville Road, Darlington, 21034
LOAD 6 (Truck 2's 1st load at Bay 2)	29402	Bel Air (2)/Joppa region	
3-19	2732	C. Milton Wright High School	1301 N. Fountain Green Road, Bel Air, 21015
3-15/3-18 /3-27	5210	Southampton Middle School	1200 Moores Mill Road, Bel Air, 21014
3-21	3052	Fountain Green Elementary School	517 S. Fountain Green Road, Bel Air, 21015
1-17/1-27	2028	The Highlands School	2409 Creswell Road, Bel Air, 21015
1-10	3815	William Paca Elementary School	2706 Old Philadelphia Road, Abingdon, 21009
1-13/1-18 /1-22/1-25 /1-26	5537	Old Post Elementary School	2706 Old Philadelphia Road, Abingdon, 21009
1-02/1-07	3913	Trinity Lutheran School	1100 Philadelphia Road, Joppa, 21085
3-07	3115	Mountain Christian Church	1624 Mountain Road, Joppa, 21085
LOAD 7 (Truck 2's 2nd load at Bay 2)	27533	Aberdeen/Havre de Grace Region	
2-01/2-15 /2-22	3361	George D. Lisby Elementary School	810 Edmund Street, Aberdeen, 21001
2-05/2-11 /6-05/6-07	3295	Aberdeen Middle School	111 Mt. Royal Avenue, Aberdeen 21001

34 polling places

Precinct	Voter Count	Polling Place Name	Address
LOAD 1	27144	Bel Air Region (1)	
3-14/3-12	4980	Bel Air High / Bel Air Middle	100 Heighe Street, Bel Air, 21014
3-16/3-17	4926	Ring Factory Elementary / Wakefield Elementary	1400 Emmorton Road, Bel Air, 21014
3-10/3-11	4996	Bel Air Elementary / Mt. Ararat Lodge	30 E. Lee Street, Bel Air, 21014
3-20/3-22	5970	Prospect Mill Elementary / Harford Tech High	101 Prospect Mill Road, Bel Air, 21015
3-02/2-02/2-07/2-21	6272	Churchville Recreation Center / Level Fire Hall	3023 Level Road, Churchville, 21028
LOAD 2	41988	Fallston/Forest Hill Region	
4-02/4-05	6139	Youths Benefit Elementary / Roni Chenowith Center	1901 Fallston Road, Fallston, 21047
3-03/3-06/3-07	10021	Fallston High / Fallston Middle / Mountain Christian	2301 Carrs Mill Road, Fallston, 21047
3-13/3-23	6258	Red Pump Elementary / St. Matthew	600 Red Pump Road, Bel Air, 21014
3-15/3-18 /3-27	5210	Southampton Middle School	1200 Moores Mill Road, Bel Air, 21014
3-09/3-24	5811	Forest Lakes Elementary / Victorious Faith	100 Osborne Parkway, Forest Hill, 21050
3-05/3-26/3-08	8549	Forest Hill Elementary / Newport Terrace	2407 Rocks Road, Forest Hill, 21050
LOAD 3	21781	Edgewood/Joppatowne Region	
1-19/1-05	5323	Edgewood High / Deerfield Elementary	2415 Willoughby Beach Road, Edgewood 21040
1-06	3213	Edgewood Recreation Center	1980 Brookside Drive, Edgewood, 21040
1-03	1830	Edgewood Elementary School	2100 Cedar Drive, Edgewood, 21040
1-01/1-24/1-41	5742	Magnolia Elementary / Riverside Elementary	901 Trimble Road, Joppa, 21085
1-45/1-04/1-23	5673	Joppatowne High / Joppatowne Elementary	555 Joppa Farm Road, Joppa, 21085
LOAD 4	26832	Abingdon Region	
1-16/1-20	6715	Church Creek Elementary / Riverside Community Center	4299 Church Creek Road, Belcamp, 21017
1-11/1-12	5916	William S. James Elementary / Abingdon Fire Hall	1 Laurentum Parkway, Abingdon, 21009
1-08/1-09/1-15	9228	Emmorton Elementary / Abingdon Library / Abingdon Elementary	2502 S.Tollgate Road, Bel Air, 21015
1-14/1-21	4973	Patterson Mill Middle/High / St. Mary	85 Patterson Mill Road, Bel Air, 21015
LOAD 5	19052	Northern Harford County	
4-03	2732	Norrisville Elementary School	5302 Norrisville Road, White Hall, 21161
4-06/4-01/4-07/4-04	8115	Jarrettsville Fire Hall / Jarrettsville Elementary / North Bend Elementary	3825 Federal Hill Road, Jarrettsville, 21084
5-02/5-03	5094	North Harford High / North Harford Elementary	211 Pylesville Road, Pylesville, 21132
5-01/5-04	3111	Dublin Elementary / Darlington Elementary	1527 Whiteford Road, Street, 21154
LOAD 6	22807	Bel Air (2)/Joppa region	
3-19/3-04	4462	C. Milton Wright High / Hickory Elementary	1301 N. Fountain Green Road, Bel Air, 21015
3-21/1-17/1-27	5080	Fountain Green Elementary / Highlands	517 S. Fountain Green Road, Bel Air, 21015
1-10/1-02/1-07	7728	William Paca Elementary / Trinity Lutheran	2706 Old Philadelphia Road, Abingdon, 21009
1-13/1-18 /1-22/1-25 /1-26	5537	Old Post Elementary School	2706 Old Philadelphia Road, Abingdon, 21009
LOAD 7	25725	Aberdeen/Havre de Grace Region	
2-03	1793	Aberdeen VFW	821 Old Philadelphia Road, Aberdeen, 21001
2-01/2-15 /2-22	3361	George D. Lisby Elementary School	810 Edmund Street, Aberdeen, 21001
2-14/2-19	2951	Hall's Cross Road Elementary School	203 East Bel Air Avenue, Aberdeen, 21001
2-04/2-10 /2-20/2-05/2-11/6-05/6-07	6331	Aberdeen High / Aberdeen Middle	251 Paradise Road, Aberdeen, 21001
6-06/6-03	6606	Havre de Grace Middle / Havre de Grace Elementary	401 Lewis Lane, Havre de Grace, 21078
6-01/6-02/6-04	4683	Havre de Grace High / Meadowvale Elementary	700 Congress Avenue, Havre de Grace, 21078

Howard County Consolidation Facts

1. Consolidations are not new in Howard County. For the last 14 years we have run consolidated polling places in Howard County. For the past four election cycles (since 2012), we have consolidated 28 precincts with other precincts for every election. (*We have 118 precincts in Howard County, but have used 90 polling places because of the 28 current consolidations.*) Seven polling places of the original 90 had to be consolidated either way because of rejection of the contract due to COVID-19. (Senior centers, some community centers, nursing home facilities, 55+ Living facilities.)
2. Howard County would typically use around 1300 judges for the Presidential General Election. We currently have 542 judges that have answered affirmatively that they will work the polls. This constitutes an emergency as there is no feasible way that we can realistically expect to open 90 sites with only 41% of judges that we need to run polling places. Even with the current local-approved consolidations, we will need 805 judges to efficiently and effectively run the polling places, which is a more realistic number than garnering 1300.
3. Howard County has consolidated 90 polling places down to 35 polling places. We took care in ensuring that distances to the new polling places were not far, and that we kept consolidated polling places in an adjacent precinct to where the voters' home district/precinct was located. In many cases, the voter will vote where they usually vote, but polling places have been combined within the facility.
4. When consolidating the precincts, we tried to keep the number of registered voters to around the 8000 voters per consolidation mark. When doing projections, taking into consideration growth, voters that would do vote-by-mail, voters that would do early voting, and voters that would not vote, the numbers end up being on par or less than most of the individual sites would have seen on Election Day. Even if the numbers were to skew a couple percentage points towards Election Day, the consolidations would still be able to handle the voters. For many of the consolidations, the number of expected voters is less than 1000. (*See attached chart, under the Proposed PG20 tab.*)
5. The voters in the consolidations will not go in and out the same doors, will see the utilization of multiple rooms for the voting process (for example- the voters may check-in in the auxiliary gym and vote in the main gym, going in a door at the auxiliary gym and exiting a door in the main gym so that the voters never cross paths), and will benefit from the additional space utilized as more people will be allowed into the voting area at one time, while still having the ability to socially and physically distance per CDC guidelines within the multiple rooms of the voting area. Even in areas where only one room will be utilized, there will be ample space to execute all of the above procedures. (*See attached sample polling place schematic.*)

6. For the voter, there will not be an apparent difference in the mechanics of the polling place. All voters will still check-in, vote, and leave as they always do. By utilizing the technology at our fingertips, the process is streamlined on the front-end, and the end customer, the voter, besides possibly visiting a different location, will not see a change in the process outside of changes being performed because of COVID-19.
7. Voters will be provided with additional signage for voter entrances, social distancing signage, and voter pathway signage throughout the polling places.
8. Judges will be provided with walkie-talkies (two-way radios) to communicate efficiently between rooms in the polling places.
9. All voters that experience a polling place change will receive a new Voter Notification Card and a specimen ballot in the mail before the election. We will continue to advertise the changes on social media and prominently on our website, as well as ensure the state and the county change their polling place locators to reflect the current iteration of consolidations.

CURRENT POLLING PLACE CONSOLIDATIONS

Dist Prct	Polling Place	Polling Location	Combined DPs	Primary DP
01-01	ELKRIDGE LANDING MIDDLE SCH	CAFETERIA	01-02	01-01
01-03	MAYFIELD WOODS MIDDLE SCHOOL	CAFETERIA	01-07	01-03
01-04	ILCHESTER ELEMENTARY SCHOOL	CAFETERIA		01-04
01-05	WORTHINGTON ELEMENTARY SCHOOL	GYM		01-05
01-06	DEEP RUN ELEMENTARY SCH	CAFETERIA		01-06
01-08	ELKRIDGE ELEMENTARY SCHOOL	CAFETERIA	01-17	01-08
01-09	MAYFIELD WOODS MIDDLE SCHOOL	GYM		01-09
01-10	HOWARD HIGH SCHOOL	GYM	02-04, 06-10	01-10
01-11	ILCHESTER ELEMENTARY SCHOOL	GYM	01-19, 01-20	01-11
01-12	ROCKBURN ELEMENTARY SCHOOL	CAFETERIA	01-14	01-12
01-13	ELKRIDGE ELEMENTARY SCHOOL	GYM		01-13
01-15	DEEP RUN ELEMENTARY SCH	GYM		01-15
01-16	DUCKETTS LANE ELEMENTARY SCHOOL	CAFETERIA	01-18, 01-21	01-16
02-01	PARK VIEW AT ELLICOTT CITY II	COMMUNITY ROOM		02-01
02-02	ELLICOTT MILLS MIDDLE SCH	CAFETERIA		02-02
02-03	ELLICOTT MILLS MIDDLE SCH	GYM		02-03
02-05	CENTENNIAL LANE ELEMENTARY SCHOOL	CAFETERIA		02-05
02-06	ST JOHNS LANE ELEM SCH	CAFETERIA		02-06
02-07	MT HEBRON HIGH SCH	CAFETERIA		02-07
02-08	HOLLIFIELD STATION ELEM SCH	CAFETERIA		02-08
02-09	THE HEARTLANDS	CAFETERIA		02-09
02-10	CENTENNIAL HIGH SCH	CAFETERIA	02-17, 02-22, 02-26, 03-04	02-10
02-11	WAVERLY ELEMENTARY SCH	GYM		02-11
02-12	ELLICOTT CITY SENIOR CENTER	MEETING RM		02-12
02-13	DUNLOGGIN MIDDLE SCH	CAFETERIA	02-14	02-13

02-15	CENTENNIAL LANE ELEMENTARY SCHOOL	GYM		02-15
02-16	WORTHINGTON ELEMENTARY SCHOOL	CAFETERIA		02-16
02-18	MT HEBRON HIGH SCH	GYM		02-18
02-19	WAVERLY ELEMENTARY SCH	CAFETERIA		02-19
02-20	NORTHFIELD ELEMENTARY SCH	CAFETERIA	02-21	02-20
02-23	HOLLIFIELD STATION ELEM SCH	GYM		02-23
02-24	PATAPSCO MIDDLE SCHOOL	GYM		02-24
02-25	BONNIE BRANCH MIDDLE SCH	CAFETERIA		02-25
03-01	WEST FRIENDSHIP ELEM SCH	CAFETERIA		03-01
03-02	MOUNT VIEW MIDDLE SCH	CAFETERIA		03-02
03-03	MANOR WOODS ELEM SCH	CAFETERIA		03-03
03-05	MOUNT VIEW MIDDLE SCH	GYM		03-05
03-06	FOLLY QUARTER MIDDLE SCHOOL	CAFETERIA		03-06
04-01	ST. MICHAEL'S CATHOLIC CHURCH	MULTI-PURPOSE ROOM	04-05	04-01
04-02	GLENELG HIGH SCH	CAFETERIA		04-02
04-03	LISBON ELEM SCH	CAFETERIA		04-03
04-04	LISBON ELEM SCH	GYM		04-04
04-06	GLENWOOD MIDDLE SCH	CAFETERIA		04-06
05-01	CLARKSVILLE ELEM SCH	CAFETERIA		05-01
05-02	LONGFELLOW ELEM SCHOOL	CAFETERIA	05-14	05-02
05-03	RESIDENCES AT VANTAGE POINT	AUDITORIUM		05-03
05-04	WILDE LAKE HIGH SCH	CAFETERIA	05-18	05-04
05-05	POINTERS RUN ELEM SCH	CAFETERIA		05-05
05-06	FULTON ELEM SCH	CAFETERIA		05-06
05-07	SWANSFIELD ELEMENTARY SCHOOL	CAFETERIA		05-07
05-08	BRYANT WOODS ELEM SCH	CAFETERIA		05-08
05-09	HARPER'S CHOICE MIDDLE SCH	GYM	05-23	05-09
05-10	RIVER HILL HIGH SCHOOL	CAFETERIA		05-10

05-11	SCHOOLEY MILL PARK	MULTI-PURPOSE ROOM	05-24	05-11
05-12	THE HAWTHORN NEIGHBOR. CNT	COMM ROOM		05-12
05-13	ATHOLTON HIGH SCH	CAFETERIA	05-17	05-13
05-15	CLEMENS CROSSING ELEM SCH	GYM		05-15
05-16	RUNNING BROOK ELEM SCH	CAFETERIA		05-16
05-19	DAYTON OAKS ELEMENTARY SCH	CAFETERIA		05-19
05-20	RESERVOIR HIGH SCHOOL	CAFETERIA		05-20
05-21	SWANSFIELD ELEMENTARY SCHOOL	GYM		05-21
05-22	CLARKSVILLE MIDDLE SCH	CAFETERIA		05-22
06-01	FOREST RIDGE ELEMENTARY SCH	GYM	06-27	06-01
06-02	HOPE BAPTIST CHURCH	MEETING ROOM		06-02
06-03	HAMMOND MIDDLE SCH	GYM	06-25	06-03
06-04	ATHOLTON ELM SCH	CAFETERIA		06-04
06-05	OAKLAND MILLS MIDDLE SCH	CAFETERIA		06-05
06-06	THUNDER HILL ELM SCH	CAFETERIA		06-06
06-07	RIDGELY'S RUN COMMUNITY CENTER	ALL PURPOSE ROOM	06-30	06-07
06-08	STEVENS FOREST ELEM SCH	CAFETERIA		06-08
06-09	TALBOTT SPRINGS ELEM SCH	CAFETERIA		06-09
06-11	JEFFERS HILL ELEM SCH	CAFETERIA		06-11
06-12	LAKE ELKHORN MIDDLE SCH	CAFETERIA	06-22	06-12
06-13	GUILFORD ELEMENTARY SCH	CAFETERIA		06-13
06-14	PHELPS LUCK ELEM SCH	CAFETERIA		06-14
06-15	LAUREL WOODS ELEMENTARY SCH	GYM		06-15
06-16	PHELPS LUCK ELEM SCH	GYM		06-16
06-17	OWEN BROWN PLACE	MEETING ROOM		06-17
06-18	HAMMOND HIGH SCH	CAFETERIA	06-23	06-18
06-19	GUILFORD ELEMENTARY SCH	GYM		06-19
06-20	PATUXENT VALLEY MIDDLE SCH	CAFETERIA		06-20

06-21	LONG REACH HIGH SCH	MAIN GYM	06-29	06-21
06-24	MURRAY HILL MIDDLE SCH	CAFETERIA		06-24
06-26	HAMMOND HIGH SCH	GYM		06-26
06-28	LIME KILN MIDDLE SCHOOL	CAFETERIA		06-28
06-31	JEFFERS HILL ELEM SCH	GYM		06-31
06-32	GORMAN CROSSING ELEM SCH	GYM		06-32
06-33	PATUXENT VALLEY MIDDLE SCH	GYM		06-33
06-34	LAUREL WOODS ELEMENTARY SCH	CAFETERIA		06-34
06-35	MURRAY HILL MIDDLE SCH	GYM		06-35

CURRENT EARLY VOTING SITES

EV-01	RIDGELY'S RUN COMM CTR	ALL PURPOSE RM
EV-02	THE BAIN CENTER	GREAT ROOMS 1 & 2
EV-03	THE MILLER BRANCH LIBRARY	THE MEETING RM
EV-04	HOWARD COUNTY FAIRGROUNDS	OLD BINGO HALL

TOTAL:

As of 07/

Voter Count
3083
3056
3161
700
1799
2727
1796
5182
1694
2798
1490
4126
3404
2371
3032
2816
1538
1597
1881
2661
2963
4227
2592
2919
1993

2228
2683
2212
1639
1381
1428
1426
1582
1781
3397
2483
4275
1975
3158
1826
2024
2595
2528
3641
1757
2763
4466
3021
4590
1735
1939
3616
3091

2580
1835
2765
2593
1899
2659
2204
2139
3487
4028
2948
2241
2157
1482
1184
2909
1491
1865
1823
2391
1484
1607
1813
2399
2246
2379
2357
1914

5429
2277
2427
2919
1372
1784
1989
1859
3995

223776

'14/2020

PROPOSED/LOCAL BOARD APPROVED PG

Dist Prct	Polling Place	Polling Location
01-01	ELKRIDGE LANDING MIDDLE SCH	CAFETERIA & GYM
01-03	ROCKBURN ELEMENTARY SCHOOL	CAFETERIA & GYM
01-04	BONNIE BRANCH MIDDLE SCH	CAFETERIA & GYM
01-05	WORTHINGTON ELEMENTARY SCH	CAFETERIA & GYM
01-06	MAYFIELD WOODS MIDDLE SCH	CAFETERIA & GYM
01-10	HOWARD HIGH SCHOOL	GYM
01-16	DUCKETTS LANE ELEMENTARY SCHOOL	CAFETERIA
02-01	ELLCOTT MILLS MIDDLE SCH	CAFETERIA & GYM
02-05	CENTENNIAL HIGH SCH	CAFETERIA
02-06	MT HEBRON HIGH SCH	CAFETERIA & GYM
02-08	PATAPSCO MIDDLE SCHOOL	
02-12	DUNLOGGIN MIDDLE SCH	
03-01	MANOR WOODS ELEM SCH	
03-02	MOUNT VIEW MIDDLE SCH	CAFETERIA & GYM
03-06	FOLLY QUARTER MIDDLE SCH	
04-01	ST. MICHAEL'S CATHOLIC CHURCH	MULTI-PURPOSE ROOM
04-04	GLENWOOD MIDDLE SCH	CAFETERIA & GYM
05-01	RIVER HILL HIGH SCHOOL	CAFETERIA
05-02	LONGFELLOW ELEM SCHOOL	
05-03	WILDE LAKE HIGH SCH	CAFETERIA
05-05	CLARKSVILLE MIDDLE SCH	CAFETERIA & GYM
05-06	FULTON ELEM SCH	
05-07	HARPER'S CHOICE MIDDLE SCH	
05-11	LIME KILN MIDDLE SCHOOL	
05-12	ATHOLTON HIGH SCH	CAFETERIA

05-20	RESERVOIR HIGH SCHOOL	CAFETERIA
06-01	PATUXENT VALLEY MIDDLE SCH	CAFETERIA & GYM
06-02	LAUREL WOODS ELEMENTARY SCH	
06-04	LAKE ELKHORN MIDDLE SCH	ELEM & MIDDLE SCHOOL CAFE
06-05	OAKLAND MILLS MIDDLE SCH	
06-07	RIDGELY'S RUN COMMUNITY CENTER	ALL PURPOSE ROOM
06-11	JEFFERS HILL ELEM SCH	CAFETERIA & GYM
06-14	LONG REACH HIGH SCH	MAIN GYM
06-18	HAMMOND HIGH SCH	CAFETERIA
06-24	MURRAY HILL MIDDLE SCH	CAFETERIA & GYM

PROPOSED EARLY VOTING SITES

EV-01	LONG REACH HIGH SCH	MAIN GYM
EV-02	WILDE LAKE HIGH SCH	GYM or CAFÉ
EV-03	MEADOWBROOK ATHLETIC COMPLEX	THE MEETING RM
EV-04	MARRIOTT'S RIDGE HIGH SCHOOL	GYM

* Assumes 2% Growth, 15% P

20 POLLING PLACE CONSOLIDATIONS

Combined DPs	Primary DP	Voter Count	Est. ED Voter Count*
01-02, 01-08, 01-13, 01-17	01-01	7300	1095
01-07, 01-12, 01-14	01-03	5854	878
01-11, 01-19, 01-20, 02-25	01-04	6437	966
02-03, 02-16	01-05	6199	930
01-09, 01-15	01-06	7721	1158
02-04, 06-10, 06-16	01-10	7581	1137
01-18, 01-21	01-16	3404	511
02-02	02-01	5403	810
02-10, 02-15, 02-17, 02-22, 02-26, 03-04	02-05	7993	1199
02-07, 02-11, 02-18, 02-19	02-06	9921	1488
02-09, 02-23, 02-24	02-08	8478	1272
02-13, 02-14, 02-20, 02-21	02-12	6293	944
03-03	03-01	4264	640
03-05	03-02	7672	1151
04-02, 05-19	03-06	6460	969
04-03, 04-05	04-01	5182	777
04-06	04-04	5123	768
05-10	05-01	6732	1010
05-08, 05-14, 05-16	05-02	5595	839
05-04, 05-18	05-03	7229	1084
05-22	05-05	6508	976
	05-06	4590	689
05-09, 05-21, 05-23	05-07	7490	1124
05-24, 06-28	05-11	5499	825
05-13, 05-15, 05-17	05-12	7193	1079

06-03, 06-25	05-20	4445	667
06-20, 06-27, 06-33	06-01	7931	1190
06-15, 06-34	06-02	6620	993
06-12, 06-17, 06-22	06-04	6794	1019
06-06, 06-08, 06-09	06-05	6022	903
06-13, 06-19, 06-30	06-07	6750	1013
06-31	06-11	3195	479
06-21, 06-29	06-14	7036	1055
06-23, 06-26	06-18	4806	721
06-32, 06-35	06-24	8056	1208

TOTALS: 223776 33567

Not Voting, 15% Early Voting and 55% VBM/ABS for a 15% TO for Election Day

*Queen Anne's County
Board of Elections*

110 Vinct St. Suite 102
Centreville, MD 21617
Phone 410-758-0832 Fax 410-758-1119
www.qacelections.com



*William E. Stoops, Board
William A. Seth, Board
Jane G. Sparks, Board
David W. Stevens, Board
Mary E. Walker, Board*

*Christine E. Jones, Director
Kimberly L. Spence, Deputy Director*

MEMO

Date: July 31, 2020
To: Linda Lamone, Administrator, SBE
From: Christine E. Jones, Election Director
Reference: Consolidation Proposal

The Queen Anne's County Board of Elections has determined that six polling places currently utilized will be consolidated due to the ongoing COVID-19 pandemic and lack of sufficient election judges to staff the polling places. This consolidation is for the 2020 Presidential General Election only.

The Queen Anne's County Board of Elections met on Thursday, July 30, 2020 and approved the Consolidation Proposal for the consolidation of 6 polling places. We are requesting approval from the State Board of Elections so that we may move forward with the consolidation and notification of voters.

01001- Sudlersville Senior Center 07001- Crumpton Fire House	02001- Church Hill Elementary School
06001- Vinct Street Conference Room	03002- Centreville Elementary School
05001- Chesapeake College	05002- Grasonville Elementary School
04001- Kent Island High School	04002- Kent Island Vol Fire Dept
04006- United Communities Vol Fire Dept	04003- Matapeake Elementary School



ST. MARY'S COUNTY
1837

BOARD OF ELECTIONS FOR ST. MARY'S COUNTY

P. O. BOX 197
41650 TUDOR HALL ROAD • LEONARDTOWN, MARYLAND 20650
Telephone: 301-475-4200 ext. *1625 • Fax: 301-475-4077

To: Nikki Charlson

Dt: 08/03/2020

Fr: Wendy Adkins

Re: Polling place changes for the 2020 General Elections

The St. Mary's County Board of Elections will have to co-locate two of our polling locations for the 2020 Elections due to COVID-19.

Precinct – 04-02 will move from Christ Church Parish Hall to co-locate to “Chopticon High School Gym”, 25390 Colton Point Road, Morganza, MD 20660. This will be a temporary change just for the 2020 Presidential Election.

Precinct 8-08 will move from Southern Maryland Higher Education Center to co-locate to “Evergreen Elementary School Media Ctr” 43765 Evergreen Way, California, MD 20619. This will be a temporary change just for the 2020 Presidential Election.

The St. Mary's County Board approved these changes on August 3, 2020.



TALBOT COUNTY BOARD OF ELECTIONS

215 BAY STREET, SUITE 7

P.O. BOX 353

EASTON, MD 21601

Email: jeri.cook@maryland.gov

PHONE: 410-770-8099 ♦ FAX: 410-770-8078

July 27, 2020

Linda Lamone, State Administrator

Ms. Lamone,

The Talbot County Board of Elections held a Special Meeting on Friday, July 24, 2020. During that Special Meeting, the Talbot County Board of Elections unanimously found that an emergency exists due to the COVID-19 pandemic requiring the consolidation of three polling places for the upcoming Presidential General Election pursuant to Maryland Annotated Code, Election Law, § 2-303(f). The reasons for the determination that an emergency exists requiring consolidation of three polling places are explained herein below. For the reasons explained herein, the Talbot County Board of Elections respectfully requests that the State Board of Elections approves such request.

Due to the recommendation in the Governor's letter dated July 8, 2020 to the State Board of Elections, that polling places should follow CDC guidelines to include physical distancing, there are three polling places in Talbot County which are small and would not allow for the recommended social distancing.

This would place the election judges and voters at potential health risk at these locations. The recommendations presented are to consolidate Wittman (05001) with Tilghman VFD (05002) and Bozman (02002), and Royal Oak (02003) with St. Michael's High School (02001).

The first recommendation is the consolidation of Wittman (746 voters) with Tilghman Volunteer Fire Department. By taking these measures this would increase Tilghman Volunteer Fire Department to 1476 voters from the current 730 voters. Tilghman Volunteer Fire Department has the required space to accommodate the recommended social distancing for these additional voters.

The second recommendation is to consolidate Bozman (566 voters) and Royal Oak (1151 voters) with St. Michael's High School. By taking this measure this would increase St. Michael's High School to 3952 voters from the current 2234 voters. St. Michael's High School conducts the election in the gymnasium which has the required space to accommodate the recommended social distancing for these additional voters.

When the local board office contacted the polling places in reference to availability, we received the following responses that should also be considered in the process of consolidating these polling places.

Bozman's response was that the church could be used "as-is" but that the church's Peninsula Delaware Conference has said they cannot use the building without disinfecting the ventilation system, which they have not done and have not used the building since the pandemic began. Without the recommended disinfection of the ventilation system being completed, it would pose unknown health risks to the election judges as well as the voters which is an additional concern to the space recommendations.

The church used for Royal Oak voters responded apprehensively by saying we could use the building but that they have not used the building since the pandemic and that the county would be responsible for conducting a "clean similar to one that was done at a local restaurant", after the election. This is an additional concern as well as the facility being too small to accommodate the space recommendations.

Talbot County Board of Elections

July 24, 2020

Page 2

Lastly, there is a considerable concern of having enough election judges for the polling places on election day. We currently have received responses from approximately one half of the election judges who are willing to work on election day. Some individuals were apprehensive in agreeing to work and there is the concern that if the pandemic becomes more aggressive and the concerns rise for their personal health and safety these election judges will reconsider their offer to work. By consolidating these polling places, it will hopefully allow us to have the appropriate number of election judges on election day.

The Talbot County Board of Elections is requesting approval of the recommended polling place consolidations for the 2020 Presidential General Election from the State Board of Elections. It is important to do everything possible to protect our election judges and the voters of Talbot County during these challenging and unpredictable times.

Respectfully,

Jeri Cook

Jeri Cook

Election Director



BOARD OF ELECTIONS

MEMO

Date: July 21, 2020
To: Linda Lamone, Administrator, SBE
From: Kaye E. Robucci, Election Director *KER*
Reference: Certified Resolutions

The Washington County Board of Elections has determined that twenty polling places currently utilized will be consolidated due to the ongoing COVID-19 pandemic and lack of sufficient election judges to staff the polling places. This consolidation is for the 2020 Presidential General Election only.

The Washington County Board of Elections met on Monday, July 20, 2020 and approved the Resolution Designating and Establishing Temporary Polling Places for the consolidation of twenty polling places. We are requesting approval from the State Board of Elections so that we may move forward with the consolidation and notification of voters.

Affected Precinct(s)	Consolidate with:
11002: Potomac Valley Fire Hall	01000: Sharpsburg Elementary School
03002: Emmanuel Methodist Church	03004: Girls, Inc.
03003: Emma K. Doub Elementary School	
06002: Boonsboro Middle School	06001: Boonsboro High School
07001: Smithsburg Elementary School	07002: Smithsburg Middle School
11001: Pleasant Valley Elementary School	08000: Pleasant Valley Baptist Church
10001: E. Russell Hicks Middle School	10002: South Hagerstown High School
10004: Washington County Technical HS	
18003: Hagerstown Community College ARCC	10003/10005: Eastern Elementary School
13002: Maugansville Ruritan Club	13001: Maugansville Elementary School
14001: Ringgold Ruritan Club	14002: Cascade Elementary School
18002/18004: Maranatha Brethren Church	18001: Bethel United Methodist Church
21001: Potomac Heights Elementary School	21002: North Hagerstown High School
21003: Northern Middle School	
22001: Trinity Lutheran Church	22002: Pangborn Elementary School
24001: WACOHU Grange Hall	23000: Heritage Academy
25003/25004: Salem Avenue Elementary School	25002: Western Heights Middle School
26004: Hickory Elementary School	26001: St. Joseph's Catholic Church Parish
26003: Valley Grace Brethren Church	26002: Lincolnshire Elementary School
27001: Fountaindale Elementary School	27002: Paramount Elementary School